

## PE100 HDPE butt fusion reducing tee

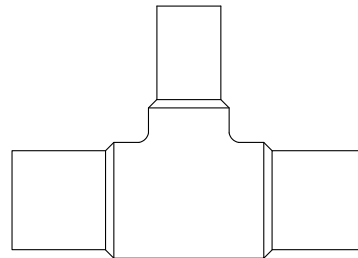

- Certificate: ISO
- Standard: ISO 4427-3, EN 12201-3
- Material: PE100 HDPE
- Feature: Molded, spigot end, butt fusion
- W. pressure: Equal to same HDPE pipe
- Color: Black



### Available size

Size		SDR 11		SDR 9		SDR 7.4		Ref. No.
DN	Min OD (mm)	Min THK (mm)	W. pressure (bar)	Min THK (mm)	W. pressure (bar)	Min THK (mm)	W. pressure (bar)	
110 x 90	110.0 x 90.0	10.0 x 8.2	PN 16	12.3 x 10.1	PN 20	15.1 x 12.3	PN 25	PL1501 (ISO)
125 x 110	125.0 x 110.0	11.4 x 10.0	PN 16	14.0 x 12.3	PN 20	17.1 x 15.1	PN 25	PL1502 (ISO)
125 x 90	125.0 x 90.0	11.4 x 8.2	PN 16	14.0 x 10.1	PN 20	17.1 x 12.3	PN 25	PL1503 (ISO)
140 x 125	140.0 x 125.0	12.7 x 11.4	PN 16	15.7 x 14.0	PN 20	19.2 x 17.1	PN 25	PL1504 (ISO)
140 x 110	140.0 x 110.0	12.7 x 10.0	PN 16	15.7 x 12.3	PN 20	19.2 x 15.1	PN 25	PL1505 (ISO)
140 x 90	140.0 x 90.0	12.7 x 8.2	PN 16	15.7 x 10.1	PN 20	19.2 x 12.3	PN 25	PL1506 (ISO)
160 x 140	160.0 x 140.0	14.6 x 12.7	PN 16	17.9 x 15.7	PN 20	21.9 x 19.2	PN 25	PL1507 (ISO)
160 x 125	160.0 x 125.0	14.6 x 11.4	PN 16	17.9 x 14.0	PN 20	21.9 x 17.1	PN 25	PL1508 (ISO)
160 x 110	160.0 x 110.0	14.6 x 10.0	PN 16	17.9 x 12.3	PN 20	21.9 x 15.1	PN 25	PL1509 (ISO)
160 x 90	160.0 x 90.0	14.6 x 8.2	PN 16	17.9 x 10.1	PN 20	21.9 x 12.3	PN 25	PL1510 (ISO)
180 x 160	180.0 x 160.0	16.4 x 14.6	PN 16	20.1 x 17.9	PN 20	24.6 x 21.9	PN 25	PL1511 (ISO)
180 x 140	180.0 x 140.0	16.4 x 12.7	PN 16	20.1 x 15.7	PN 20	24.6 x 19.2	PN 25	PL1512 (ISO)
180 x 125	180.0 x 125.0	16.4 x 11.4	PN 16	20.1 x 14.0	PN 20	24.6 x 17.1	PN 25	PL1513 (ISO)
180 x 110	180.0 x 110.0	16.4 x 10.0	PN 16	20.1 x 12.3	PN 20	24.6 x 15.1	PN 25	PL1514 (ISO)

# PE100 HDPE butt fusion reducing tee

## Available size

Size		SDR 11		SDR 9		SDR 7.4		Ref. No.
DN	Min OD (mm)	Min THK (mm)	W. pressure (bar)	Min THK (mm)	W. pressure (bar)	Min THK (mm)	W. pressure (bar)	
180 x 90	180.0 x 90.0	16.4 x 8.2	PN 16	20.1 x 10.1	PN 20	24.6 x 12.3	PN 25	PL1515 (ISO)
200 x 180	200.0 x 180.0	18.2 x 16.4	PN 16	22.4 x 20.1	PN 20	27.4 x 24.6	PN 25	PL1516 (ISO)
200 x 160	200.0 x 160.0	18.2 x 14.6	PN 16	22.4 x 17.9	PN 20	27.4 x 21.9	PN 25	PL1517 (ISO)
200 x 140	200.0 x 140.0	18.2 x 12.7	PN 16	22.4 x 15.7	PN 20	27.4 x 19.2	PN 25	PL1518 (ISO)
200 x 125	200.0 x 125.0	18.2 x 11.4	PN 16	22.4 x 14.0	PN 20	27.4 x 17.1	PN 25	PL1519 (ISO)
200 x 110	200.0 x 110.0	18.2 x 10.0	PN 16	22.4 x 12.3	PN 20	27.4 x 15.1	PN 25	PL1520 (ISO)
200 x 90	200.0 x 90.0	18.2 x 8.2	PN 16	22.4 x 10.1	PN 20	27.4 x 12.3	PN 25	PL1521 (ISO)
225 x 200	225.0 x 200.0	20.5 x 18.2	PN 16	25.2 x 22.4	PN 20	30.8 x 27.4	PN 25	PL1522 (ISO)
225 x 180	225.0 x 180.0	20.5 x 16.4	PN 16	25.2 x 20.1	PN 20	30.8 x 24.6	PN 25	PL1523 (ISO)
225 x 160	225.0 x 160.0	20.5 x 14.6	PN 16	25.2 x 17.9	PN 20	30.8 x 21.9	PN 25	PL1524 (ISO)
225 x 140	225.0 x 140.0	20.5 x 12.7	PN 16	25.2 x 15.7	PN 20	30.8 x 19.2	PN 25	PL1525 (ISO)
225 x 125	225.0 x 125.0	20.5 x 11.4	PN 16	25.2 x 14.0	PN 20	30.8 x 17.1	PN 25	PL1526 (ISO)
225 x 110	225.0 x 110.0	20.5 x 10.0	PN 16	25.2 x 12.3	PN 20	30.8 x 15.1	PN 25	PL1527 (ISO)
225 x 90	225.0 x 90.0	20.5 x 8.2	PN 16	25.2 x 10.1	PN 20	30.8 x 12.3	PN 25	PL1528 (ISO)
250 x 225	250.0 x 225.0	22.7 x 20.5	PN 16	27.9 x 25.2	PN 20	34.2 x 30.8	PN 25	PL1529 (ISO)
250 x 200	250.0 x 200.0	22.7 x 18.2	PN 16	27.9 x 22.4	PN 20	34.2 x 27.4	PN 25	PL1530 (ISO)
250 x 180	250.0 x 180.0	22.7 x 16.4	PN 16	27.9 x 20.1	PN 20	34.2 x 24.6	PN 25	PL1531 (ISO)
250 x 160	250.0 x 160.0	22.7 x 14.6	PN 16	27.9 x 17.9	PN 20	34.2 x 21.9	PN 25	PL1532 (ISO)
250 x 140	250.0 x 140.0	22.7 x 12.7	PN 16	27.9 x 15.7	PN 20	34.2 x 19.2	PN 25	PL1533 (ISO)
250 x 125	250.0 x 125.0	22.7 x 11.4	PN 16	27.9 x 14.0	PN 20	34.2 x 17.1	PN 25	PL1534 (ISO)
250 x 110	250.0 x 110.0	22.7 x 10.0	PN 16	27.9 x 12.3	PN 20	34.2 x 15.1	PN 25	PL1535 (ISO)
280 x 250	280.0 x 250.0	25.4 x 22.7	PN 16	31.3 x 27.9	PN 20	38.3 x 34.2	PN 25	PL1536 (ISO)
280 x 225	280.0 x 225.0	25.4 x 20.5	PN 16	31.3 x 25.2	PN 20	38.3 x 30.8	PN 25	PL1537 (ISO)
280 x 200	280.0 x 200.0	25.4 x 18.2	PN 16	31.3 x 22.4	PN 20	38.3 x 27.4	PN 25	PL1538 (ISO)
280 x 180	280.0 x 180.0	25.4 x 16.4	PN 16	31.3 x 20.1	PN 20	38.3 x 24.6	PN 25	PL1539 (ISO)
280 x 160	280.0 x 160.0	25.4 x 14.6	PN 16	31.3 x 17.9	PN 20	38.3 x 21.9	PN 25	PL1540 (ISO)
280 x 140	280.0 x 140.0	25.4 x 12.7	PN 16	31.3 x 15.7	PN 20	38.3 x 19.2	PN 25	PL1541 (ISO)
280 x 125	280.0 x 125.0	25.4 x 11.4	PN 16	31.3 x 14.0	PN 20	38.3 x 17.1	PN 25	PL1542 (ISO)
280 x 110	280.0 x 110.0	25.4 x 10.0	PN 16	31.3 x 12.3	PN 20	38.3 x 15.1	PN 25	PL1543 (ISO)
315 x 280	315.0 x 280.0	28.6 x 25.4	PN 16	35.2 x 31.3	PN 20	43.1 x 38.3	PN 25	PL1544 (ISO)

# PE100 HDPE butt fusion reducing tee

## Available size

Size		SDR 11		SDR 9		SDR 7.4		Ref. No.
DN	Min OD (mm)	Min THK (mm)	W. pressure (bar)	Min THK (mm)	W. pressure (bar)	Min THK (mm)	W. pressure (bar)	
315 x 250	315.0 x 250.0	28.6 x 22.7	PN 16	35.2 x 27.9	PN 20	43.1 x 34.2	PN 25	PL1545 (ISO)
315 x 225	315.0 x 225.0	28.6 x 20.5	PN 16	35.2 x 25.2	PN 20	43.1 x 30.8	PN 25	PL1546 (ISO)
315 x 200	315.0 x 200.0	28.6 x 18.2	PN 16	35.2 x 22.4	PN 20	43.1 x 27.4	PN 25	PL1547 (ISO)
355 x 315	355.0 x 315.0	32.2 x 28.6	PN 16	39.7 x 35.2	PN 20	48.5 x 43.1	PN 25	PL1548 (ISO)
355 x 280	355.0 x 280.0	32.2 x 25.4	PN 16	39.7 x 31.3	PN 20	48.5 x 38.3	PN 25	PL1549 (ISO)
355 x 250	355.0 x 250.0	32.2 x 22.7	PN 16	39.7 x 27.9	PN 20	48.5 x 34.2	PN 25	PL1550 (ISO)
355 x 225	355.0 x 225.0	32.2 x 20.5	PN 16	39.7 x 25.2	PN 20	48.5 x 30.8	PN 25	PL1551 (ISO)
355 x 200	355.0 x 200.0	32.2 x 18.2	PN 16	39.7 x 22.4	PN 20	48.5 x 27.4	PN 25	PL1552 (ISO)
400 x 355	400.0 x 355.0	36.3 x 32.2	PN 16	44.7 x 39.7	PN 20	54.7 x 48.5	PN 25	PL1553 (ISO)
400 x 315	400.0 x 315.0	36.3 x 28.6	PN 16	44.7 x 35.2	PN 20	54.7 x 43.1	PN 25	PL1554 (ISO)
400 x 280	400.0 x 280.0	36.3 x 25.4	PN 16	44.7 x 31.3	PN 20	54.7 x 38.3	PN 25	PL1555 (ISO)
400 x 250	400.0 x 250.0	36.3 x 22.7	PN 16	44.7 x 27.9	PN 20	54.7 x 34.2	PN 25	PL1556 (ISO)
400 x 225	400.0 x 225.0	36.3 x 20.5	PN 16	44.7 x 25.2	PN 20	54.7 x 30.8	PN 25	PL1557 (ISO)
400 x 200	400.0 x 200.0	36.3 x 18.2	PN 16	44.7 x 22.4	PN 20	54.7 x 27.4	PN 25	PL1558 (ISO)