

HDPE-to-steel transition coupling

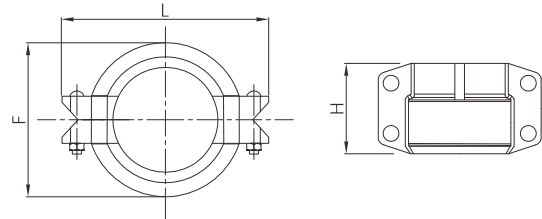

- Certificate: ISO
- Standard: Refer to ANSI / UL 213
- Housing: Ductile iron ASTM A536, 65-45-12
- Bolt & nut: CS or SS (see detail G92 ~ G96)
- Gasket: EPDM, nitrile, etc. (see detail G91)
- Connection: Plain end HDPE pipe x grooved end steel pipe
- Surface: Red painting



Available size for PE4710 HDPE pipe x ASTM steel pipe

Size		HDPE pipe thickness	Dimension (mm)			Bolting (n x bolt size)	Working pressure (psi)	Ref. No.
IPS	Ave. OD (mm)		F	L	H			
2" x 2"	60.3 x 60.3	SDR 21 ~ SDR 7	84	146	78	4 - 1/2" x 60	335	G6001 (ISO)
3" x 3"	88.9 x 88.9	SDR 21 ~ SDR 7	112	174	79	4 - 1/2" x 75	335	G6002 (ISO)
4" x 4"	114.3 x 114.3	SDR 21 ~ SDR 7	142	208	95	4 - 1/2" x 75	335	G6003 (ISO)
6" x 6"	168.3 x 168.3	SDR 21 ~ SDR 7	198	280	96	4 - 5/8" x 85	335	G6004 (ISO)
8" x 8"	219.1 x 219.1	SDR 21 ~ SDR 7	260	342	107	4 - 5/8" x 85	335	G6005 (ISO)
10" x 10"	273.1 x 273.0	SDR 21 ~ SDR 7	314	424	128	4 - 3/4" x 120	335	G6006 (ISO)
12" x 12"	323.9 x 323.8	SDR 21 ~ SDR 7	368	470	129	4 - 3/4" x 120	335	G6007 (ISO)

Available size for PE100 HDPE pipe x BS/EN steel pipe

Size		HDPE pipe thickness	Dimension (mm)			Bolting (n x bolt size)	Working pressure (bar)	Ref. No.
DN	OD (mm)		F	L	H			
63 x 50	63.0 x 60.3	SDR 17 ~ SDR 7.4	89	120	75	4 - M10 x 60	PN 25	G6021 (ISO)
110 x 100	110.0 x 114.3	SDR 17 ~ SDR 7.4	138	192	80	4 - M12 x 75	PN 25	G6022 (ISO)
160 x 150	160.0 x 165.1	SDR 17 ~ SDR 7.4	188	246	85	4 - M12 x 75	PN 25	G6023 (ISO)
160 x 150	160.0 x 168.3	SDR 17 ~ SDR 7.4	188	246	85	4 - M12 x 75	PN 25	G6024 (ISO)
200 x 200	200.0 x 219.1	SDR 17 ~ SDR 7.4	238	319	90	4 - M16 x 85	PN 25	G6025 (ISO)
250 x 250	250.0 x 273.0	SDR 17 ~ SDR 7.4	288	360	100	4 - M16 x 100	PN 25	G6026 (ISO)