

ANSI grooved flange two-piece (Flanged adapter)

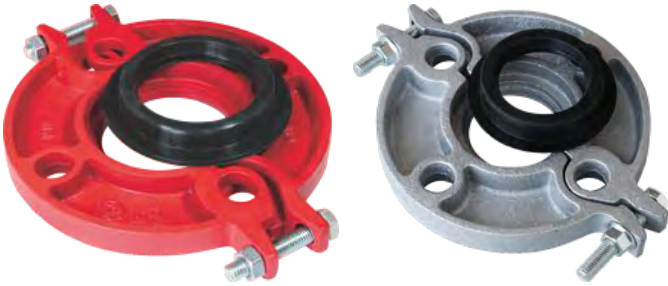

- Certificate: UL Listed / FM Approved
- Standard: ANSI / UL 213
- Housing: Ductile iron ASTM A536, 65-45-12
- Bolt & nut: Carbon steel, detail as G92 ~ G96
- Gasket: EPDM, nitrile, silicone rubber, etc.
- Mating flange: ANSI B16.1 Class 125, B16.42 Class 150, FF, RF, MF, etc.
- Rated pressure: 300 ~ 500 psi
- Surface: Red painting / hot dip galvanized

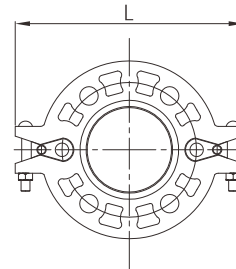

Available size of ANSI 125/150

Size			L mm	Assembly bolting (n - shank bolt)	Bolting for mating flange		Flanged end connection	Ref. No.
Inch	DN	mm			PCD (mm)	Bolt		
2"	50	60.3	206	2 - 3/8" x 50	120.7	4 x 5/8"	Class 125 / 150	G4504 (UL/FM)
2-1/2"	65	73.0	230	2 - 3/8" x 50	139.7	4 x 5/8"	Class 125 / 150	G4505 (UL/FM)
3"	80	88.9	246	2 - 3/8" x 50	152.4	4 x 5/8"	Class 125 / 150	G4507 (UL/FM)
4"	100	114.3	280	2 - 3/8" x 55	190.5	8 x 5/8"	Class 125 / 150	G4508 (UL/FM)
5"	125	141.3	320	2 - 3/8" x 65	215.9	8 x 3/4"	Class 125 / 150	G4509 (UL/FM)
6"	150	168.3	346	2 - 3/8" x 65	241.3	8 x 3/4"	Class 125 / 150	G4512 (UL/FM)
8"	200	219.1	414.3	2 - 3/8" x 70	298.5	8 x 3/4"	Class 125 / 150	G4513 (UL/FM)
10"	250	273.0	481.2	2 - 3/8" x 70	362.0	12 x 7/8"	Class 125 / 150	G4514 (UL/FM)
12"	300	323.8	553.3	2 - 3/8" x 70	431.8	12 x 7/8"	Class 125 / 150	G4515 (UL)
14"	350	355.6	590.0	/	476.3	12 x 1"	Class 125 / 150	G4516 (UL)

ANSI grooved flange two-piece (Flanged adapter)

Available size of ANSI 300

Size			L mm	Assembly bolting (n - shank bolt)	Bolting for mating flange		Flanged end connection	Ref. No.
Inch	DN	mm			PCD (mm)	Bolt		
2-1/2"	65	73.0	244	2 - 1/2" x 65	149.2	8 x 3/4"	Class 300	G4505-300 (UL/FM)
3"	80	88.9	274	2 - 1/2" x 65	168.3	8 x 3/4"	Class 300	G4507-300 (UL/FM)
4"	100	114.3	310	2 - 1/2" x 65	200.0	8 x 3/4"	Class 300	G4508-300 (UL/FM)
6"	150	168.3	388	2 - 1/2" x 65	269.9	12 x 3/4"	Class 300	G4512-300 (UL/FM)
8"	200	219.1	470.4	2 - 1/2" x 75	330.2	12 x 7/8"	Class 300	G4513-300 (UL/FM)