

Grooved concentric reducer

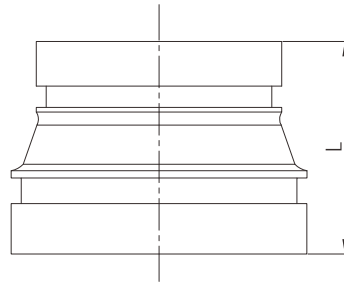

- Certificate: UL Listed / FM Approved
- Standard: ANSI / UL 213C
- Material: Ductile iron ASTM A536, 65-45-12
Stainless steel ASTM A312 304 / 316
- Rated pressure: 300 ~ 500 psi
- Surface: Red painting / hot dip galvanized
SS 304 / SS 316



Available size

Inch	Size		End to end	Ref. No.
	DN	mm	L (mm)	
1-1/4" x 1"	32 x 25	42.4 x 33.7	64	G3101 (UL/FM)
1-1/2" x 1"	40 x 25	48.3 x 33.7	64	G3102 (UL/FM)
1-1/2" x 1-1/4"	40 x 32	48.3 x 42.4	64	G3103 (UL/FM)
2" x 1"	50 x 25	60.3 x 33.7	64	G3104 (UL/FM)
2" x 1-1/4"	50 x 32	60.3 x 42.4	64	G3105 (UL/FM)
2" x 1-1/2"	50 x 40	60.3 x 48.3	64	G3106 (UL/FM)
2-1/2" x 1"	65 x 25	73.0 x 33.7	64	G3107 (UL/FM)
2-1/2" x 1-1/4"	65 x 32	73.0 x 42.4	64	G3108 (UL/FM)
2-1/2" x 1-1/2"	65 x 40	73.0 x 48.3	64	G3109 (UL/FM)
2-1/2" x 2"	65 x 50	73.0 x 60.3	64	G3110 (UL/FM)
2-1/2" x 1"	65 x 25	76.1 x 33.7	64	G3111 (UL/FM)
2-1/2" x 1-1/4"	65 x 32	76.1 x 42.4	64	G3112 (UL/FM)
2-1/2" x 1-1/2"	65 x 40	76.1 x 48.3	64	G3113 (UL/FM)
2-1/2" x 2"	65 x 50	76.1 x 60.3	64	G3114 (UL/FM)
3" x 1"	80 x 25	88.9 x 33.7	64	G3115 (UL/FM)

Grooved concentric reducer

Available size

Inch	Size		End to end	Ref. No.
	DN	mm	L (mm)	
3" x 1-1/4"	80 x 32	88.9 x 42.4	64	G3116 (UL/FM)
3" x 1-1/2"	80 x 40	88.9 x 48.3	64	G3117 (UL/FM)
3" x 2"	80 x 50	88.9 x 60.3	64	G3118 (UL/FM)
3" x 2-1/2"	80 x 65	88.9 x 73.0	64	G3119 (UL/FM)
3" x 2-1/2"	80 x 65	88.9 x 76.1	64	G3120 (UL/FM)
4" x 1-1/4"	100 x 32	114.3 x 42.4	76	G3121 (UL/FM)
4" x 1-1/2"	100 x 40	114.3 x 48.3	76	G3122 (UL/FM)
4" x 2"	100 x 50	114.3 x 60.3	76	G3123 (UL/FM)
4" x 2-1/2"	100 x 65	114.3 x 73.0	76	G3124 (UL/FM)
4" x 2-1/2"	100 x 65	114.3 x 76.1	76	G3125 (UL/FM)
4" x 3"	100 x 80	114.3 x 88.9	76	G3126 (UL/FM)
5" x 2"	125 x 50	139.7 x 60.3	89	G3127 (UL/FM)
5" x 2-1/2"	125 x 65	139.7 x 76.1	89	G3128 (UL/FM)
5" x 3"	125 x 80	139.7 x 88.9	89	G3129 (UL/FM)
5" x 4"	125 x 100	139.7 x 114.3	89	G3130 (UL/FM)
5" x 2-1/2"	125 x 65	141.3 x 73.0	89	G3131 (UL/FM)
5" x 3"	125 x 80	141.3 x 88.9	89	G3132 (UL/FM)
5" x 4"	125 x 100	141.3 x 114.3	89	G3133 (UL/FM)
6" x 2"	150 x 50	165.1 x 60.3	102	G3134 (UL/FM)
6" x 2-1/2"	150 x 65	165.1 x 76.1	102	G3135 (UL/FM)
6" x 3"	150 x 80	165.1 x 88.9	102	G3136 (UL/FM)
6" x 4"	150 x 100	165.1 x 114.3	102	G3137 (UL/FM)
6" x 5"	150 x 125	165.1 x 139.7	102	G3138 (UL/FM)
6" x 2"	150 x 50	168.3 x 60.3	102	G3139 (UL/FM)
6" x 2-1/2"	150 x 65	168.3 x 73.0	102	G3140 (UL/FM)
6" x 2-1/2"	150 x 65	168.3 x 76.1	102	G3141 (UL/FM)
6" x 3"	150 x 80	168.3 x 88.9	102	G3142 (UL/FM)
6" x 4"	150 x 100	168.3 x 114.3	102	G3143 (UL/FM)
6" x 5"	150 x 125	168.3 x 139.7	102	G3144 (UL/FM)
6" x 5"	150 x 125	168.3 x 141.3	102	G3145 (UL/FM)
8" x 2"	200 x 50	219.1 x 60.3	127	G3146 (UL/FM)
8" x 2-1/2"	200 x 65	219.1 x 73.0	127	G3147 (UL/FM)
8" x 2-1/2"	200 x 65	219.1 x 76.1	127	G3148 (UL/FM)

Grooved concentric reducer

Available size

Size			End to end	Ref. No.
Inch	DN	mm	L (mm)	
8" x 3"	200 x 80	219.1 x 88.9	127	G3149 (UL/FM)
8" x 4"	200 x 100	219.1 x 114.3	127	G3150 (UL/FM)
8" x 5"	200 x 125	219.1 x 139.7	127	G3151 (UL/FM)
8" x 5"	200 x 125	219.1 x 141.3	127	G3152 (UL/FM)
8" x 6"	200 x 150	219.1 x 165.1	127	G3153 (UL/FM)
8" x 6"	200 x 150	219.1 x 168.3	127	G3154 (UL/FM)
10" x 4"	250 x 100	273.0 x 114.3	152	G3155 (UL/FM)
10" x 6"	250 x 150	273.0 x 165.1	152	G3156 (UL/FM)
10" x 6"	250 x 150	273.0 x 168.3	152	G3157 (UL/FM)
10" x 8"	250 x 200	273.0 x 219.1	152	G3158 (UL/FM)
12" x 6"	300 x 150	323.9 x 165.1	178	G3159 (FM)
12" x 6"	300 x 150	323.9 x 168.3	178	G3160 (UL)
12" x 8"	300 x 200	323.9 x 219.1	178	G3161 (UL/FM)
12" x 10"	300 x 250	323.9 x 273.0	178	G3162 (UL/FM)