

Grooved straight tee (Equal tee)

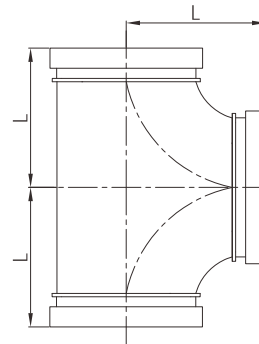

- Certificate: UL Listed / FM Approved
- Standard: ANSI / UL 213C
- Material: Ductile iron ASTM A536, 65-45-12
Stainless steel ASTM A312 304 / 316
- Type: Short / Standard
- Rated pressure: 300 ~ 500 psi
- Surface: Red painting / hot dip galvanized
SS 304 / SS 316



Available size

Size			Center to end, L (mm)		Ref. No.
Inch	DN	mm	Short	Standard	
1"	25	33.7	57	57	G1501 (UL/FM)
1-1/4"	32	42.4	60	70	G1502 (UL/FM)
1-1/2"	40	48.3	60	70	G1503 (UL/FM)
2"	50	60.3	70	83	G1504 (UL/FM)
2-1/2"	65	73.0	76	95	G1505 (UL/FM)
2-1/2"	65	76.1	76	95	G1506 (UL/FM)
3"	80	88.9	86	108	G1507 (UL/FM)
4"	100	114.3	101	127	G1508 (UL/FM)
5"	125	139.7	124	140	G1509 (UL/FM)
5"	125	141.3	124	140	G1510 (UL/FM)
6"	150	165.1	140	165	G1511 (UL/FM)
6"	150	168.3	140	165	G1512 (UL/FM)
8"	200	219.1	175	197	G1513 (UL/FM)
10"	250	273.0	215	229	G1514 (UL/FM)
12"	300	323.9	245	254	G1515 (UL/FM)

Grooved straight tee (Equal tee)

Available size

Inch	Size		Center to end, L (mm)		Ref. No.
	DN	mm	Standard	Long	
14"	350	355.6	/	280	G1516 (UL)
16"	400	406.4	/	305	G1517 (UL)
18"	450	457.2	/	342	G1518 (UL)
20"	500	508	/	381	G1519 (UL)
24"	600	609.6	/	432	G1520 (UL)