

Malleable cast iron male and female union elbow (Taper seat / flat seat)

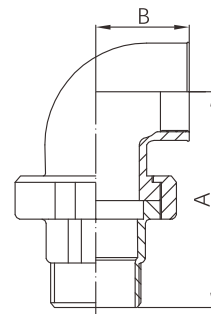

- Certificate: UL Listed / FM Approved / NSF 61
- Standard: ISO 49 / EN 10242, symbol C
- Material: BS EN 1562, EN-GJMB-350-10
- Type: Taper seat / flat seat
- Thread: BSPT
- W. pressure: 20 ~ 25 bar, ≤ PN25
- Surface: Black iron / hot dip galvanized



Available size (Source 1 with FM)

Size			A	B	Type	Ref. No.
Inch	DN	mm	mm	mm		
1/2"	15	21.3	76	28	Taper seat / flat seat	M4103 (FM)
3/4"	20	26.9	82	33	Taper seat / flat seat	M4104 (FM)
1"	25	33.7	94	38	Taper seat / flat seat	M4105 (FM)
1-1/4"	32	42.4	107	45	Taper seat / flat seat	M4106 (FM)
1-1/2"	40	48.3	115	50	Taper seat / flat seat	M4107 (FM)
2"	50	60.3	128	58	Taper seat / flat seat	M4108 (ISO)

Note:

1. For taper (conical) seat, it is self-sealing without gasket.
2. For flat seat, it requires a separate gasket for sealing. TPMC could supply the rubber gasket as an optional accessory.

Malleable cast iron male and female union elbow (Taper seat / flat seat)

Available size (Source 2 with UL)

Size			A	B	Type	Ref. No.
Inch	DN	mm	mm	mm		
1/2"	15	21.3	68 / 72	27 / 25	Taper seat / flat seat	M4123 (UL)
3/4"	20	26.9	77 / 80	32 / 29	Taper seat / flat seat	M4124 (UL)
1"	25	33.7	87 / 90	37 / 35	Taper seat / flat seat	M4125 (UL)
1-1/4"	32	42.4	100 / 105	45 / 42	Taper seat / flat seat	M4126 (UL)
1-1/2"	40	48.3	107 / 111	49 / 46	Taper seat / flat seat	M4127 (UL)
2"	50	60.3	122 / 125	57 / 54	Taper seat / flat seat	M4128 (UL)

Note:

1. For taper (conical) seat, it is self-sealing without gasket.
2. For flat seat, it requires a separate gasket for sealing. TPMC could supply the rubber gasket as an optional accessory.
3. This UL listed union is certified to NSF/ANSI/CAN 61 for use in drinking water systems.