

Malleable cast iron union elbow (Taper seat / flat seat)

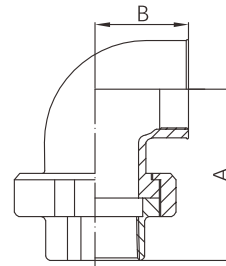

- Certificate: UL Listed / FM Approved / NSF 61
- Standard: ISO 49 / EN 10242, symbol C
- Material: BS EN 1562, EN-GJMB-350-10
- Type: Taper seat / flat seat
- Thread: BSPT
- W. pressure: 20 ~ 25 bar, ≤ PN25
- Surface: Black iron / hot dip galvanized



Available size

Size			A	B	Type	Ref. No.
Inch	DN	mm	mm	mm		
1/2"	15	21.3	57	27	Taper seat / flat seat	M4003 (UL/FM)
3/4"	20	26.9	59	29	Taper seat / flat seat	M4004 (UL/FM)
1"	25	33.7	72	34	Taper seat / flat seat	M4005 (UL/FM)
1-1/4"	32	42.4	82	43	Taper seat / flat seat	M4006 (UL/FM)
1-1/2"	40	48.3	88	47	Taper seat / flat seat	M4007 (UL/FM)
2"	50	60.3	99	56	Taper seat / flat seat	M4008 (UL/FM)

Note:

1. For taper (conical) seat, it is self-sealing without gasket.
2. For flat seat, it requires a separate gasket for sealing. TPMC could supply the rubber gasket as an optional accessory.
3. NSF/ANSI/CAN 61 certificate is available for M4003 ~ M4008.