

## Malleable cast iron male and female union (Taper seat / flat seat)

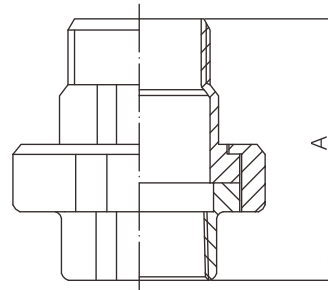

- Certificate: UL Listed / FM Approved / NSF 61
- Standard: ISO 49 / EN 10242, symbol C
- Material: BS EN 1562, EN-GJMB-350-10
- Type: Taper seat / flat seat
- Thread: BSPT
- W. pressure: 20 ~ 25 bar, ≤ PN25
- Surface: Black iron / hot dip galvanized



### Available size (Source 1 with FM)

Size			A	Type	Ref. No.
Inch	DN	mm	mm		
1/2"	15	21.3	66	Taper seat / flat seat	M3903 (FM)
3/4"	20	26.9	72	Taper seat / flat seat	M3904 (FM)
1"	25	33.7	80	Taper seat / flat seat	M3905 (FM)
1-1/4"	32	42.4	90	Taper seat / flat seat	M3906 (FM)
1-1/2"	40	48.3	95	Taper seat / flat seat	M3907 (FM)
2"	50	60.3	106	Taper seat / flat seat	M3908 (FM)
2-1/2"	65	76.1	118	Taper seat / flat seat	M3909 (FM)
3"	80	88.9	130	Taper seat / flat seat	M3910 (FM)
4"	100	114.3	133	Taper seat / flat seat	M3911 (FM)

**Note:**

1. For taper (conical) seat, it is self-sealing without gasket. A brass ring is press-fitted to enhance the sealing performance.
2. For flat seat, it requires a separate gasket for sealing. TPMC could supply the rubber gasket as an optional accessory.

## Malleable cast iron male and female union (Taper seat / flat seat)

### Available size (Source 2 with UL)

Size			A	Type	Ref. No.
Inch	DN	mm	mm		
1/2"	15	21.3	65 / 64	Taper seat / flat seat	M3923 (UL)
3/4"	20	26.9	72 / 70	Taper seat / flat seat	M3924 (UL)
1"	25	33.7	79 / 78	Taper seat / flat seat	M3925 (UL)
1-1/4"	32	42.4	90 / 88	Taper seat / flat seat	M3926 (UL)
1-1/2"	40	48.3	96 / 93	Taper seat / flat seat	M3927 (UL)
2"	50	60.3	107 / 104	Taper seat / flat seat	M3928 (UL)

**Note:**

1. For taper (conical) seat, it is self-sealing without gasket. A brass ring is press-fitted to enhance the sealing performance.
2. For flat seat, it requires a separate gasket for sealing. TPMC could supply the rubber gasket as an optional accessory.
3. This UL listed union is certified to NSF/ANSI/CAN 61 for use in drinking water systems.