

## Malleable cast iron union (Taper seat / flat seat)

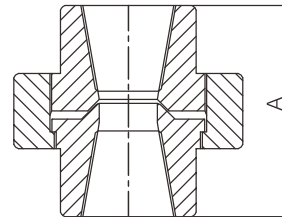

- Certificate: UL Listed / FM Approved / NSF 61
- Standard: ISO 49 / EN 10242, symbol C
- Material: BS EN 1562, EN-GJMB-350-10
- Type: Taper seat / flat seat
- Thread: BSPT
- W. pressure: 20 ~ 25 bar, ≤ PN25
- Surface: Black iron / hot dip galvanized



### Available size (Source 1 with FM)

Size			A	Type	Ref. No.
Inch	DN	mm	mm		
1/4"	8	13.5	42	Taper seat / flat seat	M3801 (FM)
3/8"	10	17.2	45	Taper seat / flat seat	M3802 (FM)
1/2"	15	21.3	48	Taper seat / flat seat	M3803 (FM)
3/4"	20	26.9	52	Taper seat / flat seat	M3804 (FM)
1"	25	33.7	58	Taper seat / flat seat	M3805 (FM)
1-1/4"	32	42.4	65	Taper seat / flat seat	M3806 (FM)
1-1/2"	40	48.3	70	Taper seat / flat seat	M3807 (FM)
2"	50	60.3	78	Taper seat / flat seat	M3808 (FM)
2-1/2"	65	76.1	85	Taper seat / flat seat	M3809 (FM)
3"	80	88.9	95	Taper seat / flat seat	M3810 (FM)
4"	100	114.3	100	Taper seat / flat seat	M3811 (FM)
6"	150	165.1	144	Taper seat / flat seat	M3813 (ISO)

#### Note:

1. For taper (conical) seat, it is self-sealing without gasket. A brass ring is press-fitted to enhance the sealing performance.
2. For flat seat, it requires a separate gasket for sealing. TPMC could supply the rubber gasket as an optional accessory.

## Malleable cast iron union (Taper seat / flat seat)

### Available size (Source 2 with UL)

Size			A	Type	Ref. No.
Inch	DN	mm	mm		
1/4"	8	13.5	42	Taper seat	M3821 (ISO)
3/8"	10	17.2	45	Taper seat	M3822 (ISO)
1/2"	15	21.3	47 / 46	Taper seat / flat seat	M3823 (UL)
3/4"	20	26.9	52 / 50	Taper seat / flat seat	M3824 (UL)
1"	25	33.7	57 / 56	Taper seat / flat seat	M3825 (UL)
1-1/4"	32	42.4	65 / 63	Taper seat / flat seat	M3826 (UL)
1-1/2"	40	48.3	71 / 68	Taper seat / flat seat	M3827 (UL)
2"	50	60.3	79 / 76	Taper seat / flat seat	M3828 (UL)
2-1/2"	65	76.1	86 / 83	Taper seat / flat seat	M3829 (UL)
3"	80	88.9	95 / 93	Taper seat / flat seat	M3830 (UL)
4"	100	114.3	111 / 114	Taper seat / flat seat	M3831 (UL)

#### Note:

1. For taper (conical) seat, it is self-sealing without gasket. A brass ring is press-fitted to enhance the sealing performance.
2. For flat seat, it requires a separate gasket for sealing. TPMC could supply the rubber gasket as an optional accessory.
3. This UL listed union is certified to NSF/ANSI/CAN 61 for use in drinking water systems.