

Swinging pipe fire hose reel (Automatic)

Swinging fire hose reel is normally installed in a building for the occupants to extinguish a small fire. It could swing over 170°. For automatic type, rotation of the reel opens the valve automatically to release water.

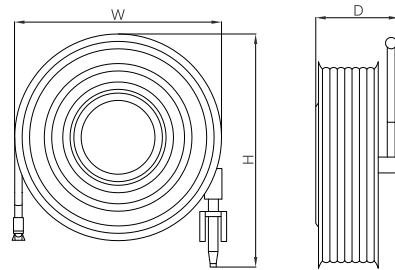

- Certificate: LPCB Approved
- Standard: BS EN 671-1
- W. pressure: 12 bar
- Test / burst: 18 bar / 30 bar
- Hose color: Red or black
- Surface: Red powder coating (RAL 3000)



Main parts and material

| | | | |
|------------------------|--|----------------------------------|--|
| Semi-rigid hose | PVC tubing as EN 694 | Shut-off nozzle | Nylon or brass, rotary operated jet / spray |
| Reel | Carbon steel or SS to two side plates (disc), brass waterway | Inlet stop valve 1" brass | Standard: Ball valve, lever operated; Optional: Gate valve, handwheel or lockshield |

Available size

| Size | Hose bore (mm) | Hose length (m) | Nozzle material | Nozzle size (mm) | Overall size H x W x D (mm) | Ref. No. |
|---------------|----------------|-----------------|-----------------|------------------|-----------------------------|----------|
| 19 x 30, 3/4" | 19 | 30 | Nylon | 6 | 580 x 620 x 260 | FE6501 |
| 19 x 30, 3/4" | 19 | 30 | Brass | 6 | 580 x 620 x 260 | FE6502 |
| 25 x 30, 1" | 25 | 30 | Nylon | 7 | 600 x 640 x 260 | FE6503 |
| 25 x 30, 1" | 25 | 30 | Brass | 8 | 600 x 640 x 260 | FE6504 |

Note:

1. It is wall mounted or cabinet mounted, available left or right hand.
2. A rectangular shaped wall mounting bracket is equipped.
3. It is also available to add a pressure gauge, which can be located in the middle of the disc or at the inlet of stop valve.