

Strut channel, slotted or solid

Strut channel is a structural component used to support or brace piping. It is made by cold formed steel sheet or stainless steel, folded over into an U shape with inwards-curving lips to provide additional stiffness. It can be solid or slotted type.

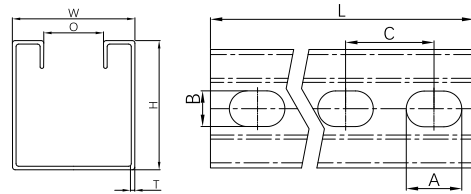

- Certificate: ISO
- Standard: Refer to MSS SP-58, GB/T 6723
- Material: Carbon steel / stainless steel
- Length: 10ft, 20ft, 3m, or customized
- Surface: Pre-galvanized / electro-galvanized / hot dip galvanized, painted, etc.



Available size (Inch / imperial)

Height (H)	Width (W)	Open mouth (O)	Length (feet)	Thickness (T)	Type		Ref. No.
					Slotted	Solid	
1-5/8"	1-5/8"	7/8"	10 / 20	14 GA (2.0mm) / 12 GA (2.8mm)	Slotted	Solid	P8101
13/16"	1-5/8"	7/8"	10 / 20	14 GA (2.0mm) / 12 GA (2.8mm)	Slotted	Solid	P8102
2-7/16"	1-5/8"	7/8"	10 / 20	12 GA (2.8mm)	Slotted	Solid	P8103
3-1/4"	1-5/8"	7/8"	10 / 20	14 GA (2.0mm) / 12 GA (2.8mm)	Slotted	Solid	P8104
3-1/4"	1-5/8"	7/8"	10 / 20	12 GA (2.8mm)	Slotted	/	P8105

Available size (Metric)

Height H (mm)	Width W (mm)	Open mouth O (mm)	Length (m)	Thickness T (mm)	Type		Ref. No.
					Slotted	Solid	
41	41	22	3, 6, etc	1.2 / 1.5 / 1.8 / 2.0 / 2.5, etc	Slotted	Solid	P8111
21	41	22	3, 6, etc	1.2 / 1.5 / 1.8 / 2.0 / 2.5, etc	Slotted	Solid	P8112
52	41	22	3, 6, etc	1.2 / 1.5 / 1.8 / 2.0 / 2.5, etc	Slotted	Solid	P8113
62	41	22	3, 6, etc	1.2 / 1.5 / 1.8 / 2.0 / 2.5, etc	Slotted	Solid	P8114
72	41	22	3, 6, etc	1.2 / 1.5 / 1.8 / 2.0 / 2.5, etc	Slotted	Solid	P8115

Note: Slotted dimension is usually as "A=28.6mm, B=14.3mm, C=50.8mm". Other dimensions are available.