

# Eye rod

Eye rod is a round steel bar with machined threads on its partial length at one end, and with an oval eye at the other end. It is used to connect pipe clamp or riser clamp to make up a pipe hanger assembly.

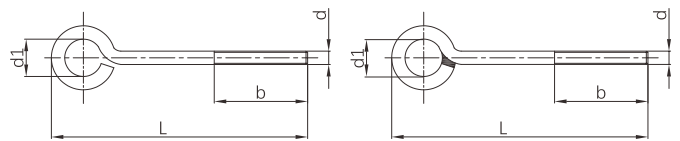

- Certificate: ISO
- Standard: MSS SP-58, GB/T 17116.3
- Type: Single head threaded eye rod, open or closed type
- Material: Carbon steel
- Surface: Plain / Electro-galvanized
- Application: Ideal for applications where longer threaded rod is not needed



Open type

Closed type



## Available size

Size	Length (mm)	Dia (mm)	Dia (mm)	Dia (mm)	Max recommend load (N)	Ref. No.
	L	d	d1	b		
M10	500	10	13.5	125 (355)	1120	P7401
M12	1000	12	17.5	125 (355)	1600	P7402
M16	1500	16	21.5	125 (400)	3150	P7403
M20	2000	20	26.5	140 (400)	5000	P7404
M24	2500	24	32	140 (400)	7100	P7405
M30	3000	30	37	160 (400)	11200	P7406

### Note:

1. For "b", it can be left threaded or right threaded.
2. For "b", dimensions in brackets shall be used when it is in conjunction with long-type turnbuckle.
3. Max recommend load is suitable for open type only.
4. Other size is available.