

Purlin clamp

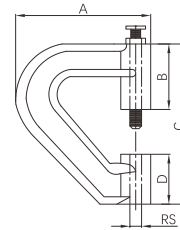

- Certificate: UL Listed / FM Approved
- Standard: UL 203, MSS SP-58/69 (Type-23)
- Material: Ductile iron body, hardened steel cup point set screw and locknut
- Surface: Plain black / electro-galvanized
- Application: Attachment to steel purlin



Available size

Pipe size		Hanger Rod Size (RS)		Dimension (mm)				Max recommend load (N)	Ref. No.
NPS	DN	UNC	Metric	A	B	C	D		
1/2" ~ 4"	15 ~ 100	3/8"	M10	72	36	88	16	1780	P5201

Note: It is approved for use with set screw on load side only.

C clamp



- Certificate: FM Approved
- Standard: UL 203, MSS SP-58/69 (Type-23)
- Material: Carbon steel / malleable iron, hardened steel cup point set screw and locknut
- Surface: Plain / electro-galvanized
- Application: Attachment to beam, channel, etc.

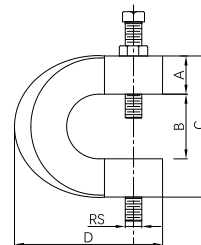

Available size

Pipe size		Hanger Rod Size (RS)		Dimension (mm)				Max recommend load (N)	Ref. No.
NPS	DN	UNC	Metric	A	B	C	D		
1/2" ~ 4"	15 ~ 100	3/8"	M10	13	19	45	48	1780	P5301

Note: It is approved for use with set screw on load side only.