

Rubber lined split clamp

Rubber lined split clamp is mainly used with light steel pipe or CPVC pipe, and it is lined by EPDM to reduce noise and vibration as DIN 4109/ISO 3822-1. Two set screws are equipped for quick installation.

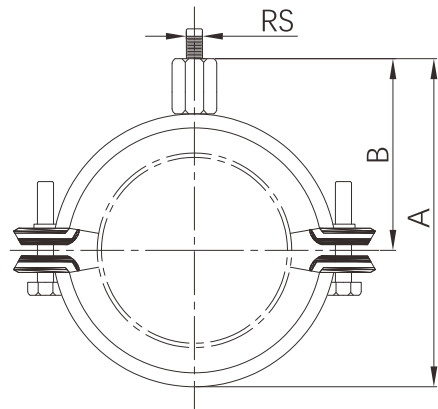

- Certificate: UL Listed / FM Approved
- Standard: MSS SP-58/69 (Type-12)
- Type: Two set screws, M6
- Material: Carbon steel + EPDM lining
- Surface: Pre-galvanized / electro-galvanized
- Application: Non-insulated stationary pipeline



Available size (Source 1)

Pipe size		Hanger Rod Size (RS)		Dimension (mm)		Max recommend load (N)	Ref. No.
NPS	DN	UNC	Metric	A	B		
1/2"	15	3/8"	M10	51	34	1334	P4601 (UL)
3/4"	20	3/8"	M10	56	36	1334	P4602 (UL/FM)
1"	25	3/8"	M10	63	40	1334	P4603 (UL/FM)
1-1/4"	32	3/8"	M10	71	44	1334	P4604 (UL/FM)
1-1/2"	40	3/8"	M10	78	47	1334	P4605 (UL/FM)
2"	50	3/8"	M10	96	59	1334	P4606 (UL/FM)
2-1/2"	65	3/8"	M10	111	67	1512	P4607 (UL/FM)
3"	80	3/8"	M10	124	73	1868	P4608 (UL/FM)
4"	100	3/8"	M10	155	89	2668	P4609 (UL/FM)
5"	125	1/2"	M12	183	102	3558	P4610 (UL/FM)
6"	150	1/2"	M12	210	116	4714	P4611 (UL/FM)
8"	200	1/2"	M12	270	147	7205	P4612 (UL/FM)
10"	250	5/8"	M16	327	175	10408	P4613 (UL/FM)
12"	300	5/8"	M16	377	201	14055	P4614 (UL/FM)

Note: It is UL listed and FM approved with or without rubber lining.

Rubber lined split clamp

Available size (Source 2)

Pipe size		Hanger Rod Size (RS)		Dimension (mm)		Max recommend load (N)	Ref. No.
NPS	DN	UNC	Metric	A	B		
1/2"	15	3/8"	M10	51	34	1200	P4621 (ISO)
3/4"	20	3/8"	M10	55	36	1200	P4622 (ISO)
1"	25	3/8"	M10	63	40	1300	P4623 (ISO)
1-1/4"	32	3/8"	M10	71	44	1300	P4624 (ISO)
1-1/2"	40	3/8"	M10	79	48	1300	P4625 (ISO)
2"	50	3/8"	M10	89	53	1300	P4626 (ISO)
2-1/2"	65	3/8"	M10	103	60	1900	P4627 (ISO)
3"	80	3/8"	M10	118	68	1900	P4628 (ISO)
4"	100	3/8"	M10	141	79	2300	P4629 (ISO)
5"	125	1/2"	M12	175	96	2700	P4630 (ISO)
6"	150	1/2"	M12	202	110	2700	P4631 (ISO)
8"	200	1/2"	M12	248	133	2990	P4632 (ISO)
10"	250	9/16"	M14	288	155	2990	P4633 (ISO)
12"	300	9/16"	M14	320	180	2990	P4634 (ISO)