

Riser clamp

Riser clamp is designed for supporting and stabilizing vertical pipe runs, and normally it is not used with hanger rod. Its ears have been extended to permit the transfer of the piping load to a bearing surface.

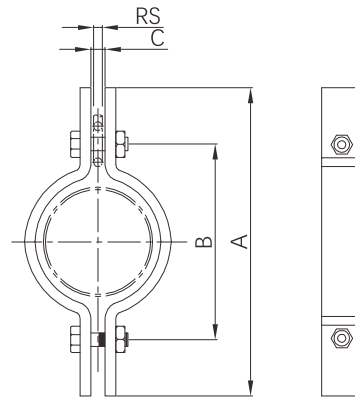

- Certificate: UL Listed / FM Approved
- Standard: UL 203, MSS SP-58/69 (Type-8)
- Material: Carbon steel
- Surface: Pre-galvanized / electro-galvanized
- Application: Vertical riser



Available size (Source 1)

Pipe size		Hanger Rod Size (RS)		Dimension (mm)			Max recommend load (N)	Ref. No.
NPS	DN	UNC	Metric	A	B	C		
1/2"	15	3/8"	M10	223	75	/	1334	P4501 (UL)
3/4"	20	3/8"	M10	229	81	/	1334	P4502 (UL/FM)
1"	25	3/8"	M10	235	87	/	1334	P4503 (UL/FM)
1-1/4"	32	3/8"	M10	244	96	/	1334	P4504 (UL/FM)
1-1/2"	40	3/8"	M10	250	102	/	1334	P4505 (UL/FM)
2"	50	1/2"	M12	262	114	/	1334	P4506 (UL/FM)
2-1/2"	65	1/2"	M12	278	130	/	1512	P4507 (UL/FM)
3"	80	1/2"	M12	291	143	/	1868	P4508 (UL/FM)
4"	100	1/2"	M12	326	192	/	2668	P4509 (UL/FM)
5"	125	1/2"	M12	362	228	/	3558	P4510 (UL/FM)
6"	150	1/2"	M12	390	256	/	4714	P4511 (UL/FM)
8"	200	5/8"	M16	461	327	/	7205	P4512 (UL/FM)
10"	250	5/8"	M16	515	381	/	10408	P4513 (UL/FM)
12"	300	5/8"	M16	566	432	/	14055	P4514 (UL/FM)

Riser clamp

Available size (Source 2)

Pipe size		Hanger Rod Size (RS)		Dimension (mm)			Max recommend load (N)	Ref. No.
NPS	DN	UNC	Metric	A	B	C		
1/2"	15	3/8"	M10	225	80	12	2220	P4521 (ISO)
3/4"	20	3/8"	M10	225	80	12	2220	P4522 (FM)
1"	25	3/8"	M10	225	80	12	2220	P4523 (FM)
1-1/4"	32	3/8"	M10	255	110	12	2220	P4524 (FM)
1-1/2"	40	3/8"	M10	260	115	12	2220	P4525 (FM)
2"	50	1/2"	M12	260	120	12	2220	P4526 (FM)
2-1/2"	65	1/2"	M12	285	135	12	2220	P4527 (FM)
3"	80	1/2"	M12	290	140	16	2220	P4528 (FM)
4"	100	1/2"	M12	330	180	16	2220	P4529 (FM)
5"	125	1/2"	M12	350	205	18	4400	P4530 (FM)
6"	150	1/2"	M12	375	230	18	4400	P4531 (FM)
8"	200	5/8"	M16	470	305	18	5544	P4532 (FM)
10"	250	5/8"	M16	515	370	18	5544	P4533 (FM)
12"	300	5/8"	M16	580	415	18	5544	P4534 (FM)