

Brass filtering reducing valve

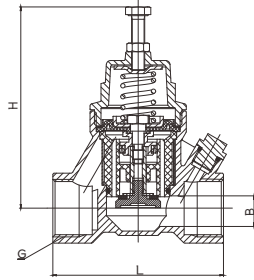

- Certificate: ISO
- Material: Brass
- Connection: Thread female, BSPP (G) / BSPT / NPT
- Adjustment: 21.75 ~ 65.25 psi
- Temperature: 0°C to 80°C
- W. pressure: PN 16 (1.6 MPa)
- Surface: Rough brass

Available size

Size		Dimension (mm)			Connection	Working pressure	Ref. No.
Inch	DN	L	H	B			
1/2"	15	78	91	14	BSPP (G) / BSPT / NPT	PN 16	VC2101
3/4"	20	78	91	14	BSPP (G) / BSPT / NPT	PN 16	VC2102
1"	25	94	119	16	BSPP (G) / BSPT / NPT	PN 16	VC2103
1-1/4"	32	125	138	26	BSPP (G) / BSPT / NPT	PN 16	VC2104
1-1/2"	40	125	138	26	BSPP (G) / BSPT / NPT	PN 16	VC2105
2"	50	145	157	32	BSPP (G) / BSPT / NPT	PN 16	VC2106

Brass adjustable pressure reducing valve (with pressure gauge)

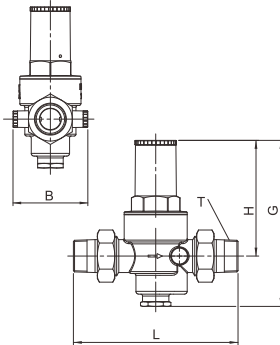

- Certificate: ISO
- Material: Brass
- Connection: Thread male, BSPP (G) / BSPT / NPT
- Adjustment: 14.5 ~ 87 psi
- Temperature: 0°C to 80°C
- W. pressure: PN 16 (1.6 MPa)
- Surface: Rough brass

Available size

Size		Dimension (mm)			Connection	Working pressure	Ref. No.
Inch	DN	L	H	B			
1/2"	15	149	98	65	BSPP (G) / BSPT / NPT	PN 16	VC2201
3/4"	20	169	114	74	BSPP (G) / BSPT / NPT	PN 16	VC2202
1"	25	195	123	82	BSPP (G) / BSPT / NPT	PN 16	VC2203
1-1/4"	32	198	136	88	BSPP (G) / BSPT / NPT	PN 16	VC2204
1-1/2"	40	209	150	98	BSPP (G) / BSPT / NPT	PN 16	VC2205
2"	50	228	167	102	BSPP (G) / BSPT / NPT	PN 16	VC2206