

Sway brace fitting (Universal sway brace clamp)

Sway brace fitting is a device used to attach the brace member of the sway brace to the fire sprinkler piping. For universal sway brace clamp, it is used for both lateral and longitudinal sway brace applications.

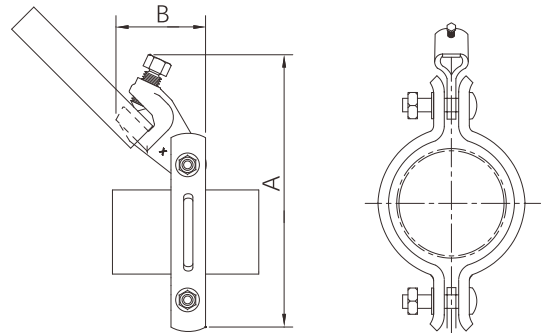

- Certificate: UL Listed / FM Approved
- Standard: UL 203A, refer to NFPA 13 seismic sway bracing
- Material: Carbon steel brace + cast iron clamp
- Surface: Electro-galvanized
- Application: Attach to fire sprinkler piping, lateral & longitudinal direction



Available size

Sprinkler pipe to be braced		Sprinkler pipe thickness	Orientation	Dimension (mm)		Ref. No.
NPS	DN			A	B	
1"	25	Sch10 / Sch40	Lateral / longitudinal	175	25	P6603 (FM)
1-1/4"	32	Sch10 / Sch40	Lateral / longitudinal	187	25	P6604 (FM)
1-1/2"	40	Sch10 / Sch40	Lateral / longitudinal	197	25	P6605 (FM)
2"	50	Sch10 / Sch40	Lateral / longitudinal	206	30	P6606 (UL/FM)
2-1/2"	65	Sch10 / Sch40	Lateral / longitudinal	225	30	P6607 (UL/FM)
3"	80	Sch10 / Sch40	Lateral / longitudinal	238	30	P6608 (UL/FM)
4"	100	Sch10 / Sch40	Lateral / longitudinal	270	38	P6609 (UL/FM)
5"	125	Sch10 / Sch40	Lateral / longitudinal	308	38	P6610 (UL/FM)
6"	150	Sch10 / Sch40	Lateral / longitudinal	346	51	P6611 (UL/FM)
8"	200	Sch10 / Sch40	Lateral / longitudinal	400	51	P6612 (UL/FM)
10"	250	Sch10 / Sch40	Lateral / longitudinal	457	51	P6613 (UL/FM)

Note: As FM rule, brace pipe is available with NPS Sch40 pipe 1", 1-1/4", 1-1/2", or 2", or other pipes as FM specific specification.