

## Swinging pipe fire hose reel (Automatic)

Swinging fire hose reel is normally installed in a building for the occupants to extinguish a small fire. It could swing over 170°. For automatic type, rotation of the reel opens the valve automatically to release water.

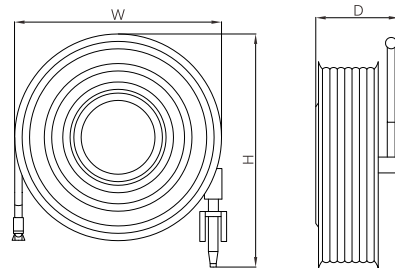

- Certificate: LPCB Approved
- Standard: BS EN 671-1
- W. pressure: 12 bar
- Test / burst: 18 bar / 30 bar
- Hose color: Red or black
- Surface: Red powder coating (RAL 3000)



### Main parts and material

<b>Semi-rigid hose</b>	PVC tubing as EN 694	<b>Shut-off nozzle</b>	Nylon or brass, rotary operated jet / spray
<b>Reel</b>	Carbon steel or SS to two side plates (disc), brass waterway	<b>Inlet stop valve 1" brass</b>	Standard: Ball valve, lever operated; Optional: Gate valve, handwheel or lockshield

### Available size

Size	Hose bore (mm)	Hose length (m)	Nozzle material	Nozzle size (mm)	Overall size H x W x D (mm)	Ref. No.
DN 19 (3/4") x 30	19	30	Nylon	6	580 x 620 x 260	FE6501
DN 19 (3/4") x 30	19	30	Brass	6	580 x 620 x 260	FE6502
DN 25 (1") x 30	25	30	Nylon	7	600 x 640 x 260	FE6503
DN 25 (1") x 30	25	30	Brass	8	600 x 640 x 260	FE6504

#### Note:

1. It is wall mounted or cabinet mounted, available left or right hand.
2. A rectangular shaped wall mounting bracket is equipped.
3. It is also available to add a pressure gauge, which can be located in the middle of the disc or at the inlet of stop valve.