

Channel gasket (Channel washer)



- Certificate: ISO
- Standard: Refer to MSS SP-58
- Material: Carbon steel
- Type: One hole / two holes
- Surface: Hot dip galvanized / electro-galvanized

Available size

Rod size (RS)		Hole size (HS)	Number of hole	Ref. No.
UNC	Metric			
5/16"	M8	3/8"	One hole / two holes	P8401
3/8"	M10	7/16"	One hole / two holes	P8402
1/2"	M12	9/16"	One hole / two holes	P8403
5/8"	M16	11/16"	One hole / two holes	P8404
3/4"	M20	13/16"	One hole / two holes	P8405
7/8"	M22	15/16"	One hole / two holes	P8406

Adjustable pipe saddle support

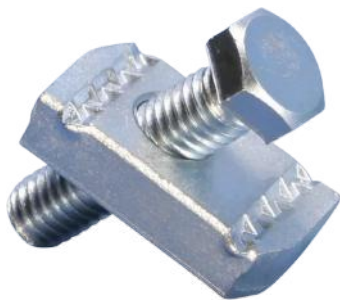

- Certificate: ISO
- Standard: Refer to MSS SP-58
- Material: Carbon steel
- Surface: Hot dip galvanized / electro-galvanized
- Application: Secure slotted strut channel to threaded rod for stiffening

Available size

Rod size (RS)		Strut type	Material	Ref. No.
UNC	Metric			
3/8"	M10	41 x 41 mm	Steel	P8501
1/2"	M12	41 x 41 mm	Steel	P8502
5/8"	M16	41 x 41 mm	Steel	P8503
3/4"	M20	41 x 41 mm	Steel	P8504