

NPT x BSPT threaded female and male adaptor

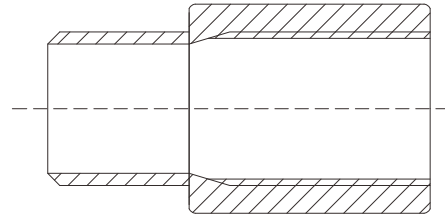

- Certificate: ISO
- Standard: Refer to ASME B16.11
- Material: Forged carbon steel ASTM A105
Forged SS ASTM A182, F304 / F316L
- Threaded: NPT / BSPT, female and male
- W. pressure: Class 3000, 6000
- Surface: Oiled / hot dip galvanized
Pickling white, etc.



Available size

Size			Working pressure	Connection	Ref. No.
NPS	DN	OD (mm)			
1/2" x 3/8"	15 x 10	21.3 x 17.1	Class 3000 / 6000	NPT F x BSPT M, BSPT F x NPT M	N8501
1/2" x 1/2"	15 x 15	21.3 x 21.3	Class 3000 / 6000	NPT F x BSPT M, BSPT F x NPT M	N8502
3/4" x 1/2"	20 x 15	26.7 x 21.3	Class 3000 / 6000	NPT F x BSPT M, BSPT F x NPT M	N8503
3/4" x 3/4"	20 x 20	26.7 x 26.7	Class 3000 / 6000	NPT F x BSPT M, BSPT F x NPT M	N8504
1" x 1/2"	25 x 15	33.4 x 21.3	Class 3000 / 6000	NPT F x BSPT M, BSPT F x NPT M	N8505
1" x 3/4"	25 x 20	33.4 x 26.7	Class 3000 / 6000	NPT F x BSPT M, BSPT F x NPT M	N8506
1" x 1"	25 x 25	33.4 x 33.4	Class 3000 / 6000	NPT F x BSPT M, BSPT F x NPT M	N8507
1-1/4" x 1/2"	32 x 15	42.2 x 21.3	Class 3000 / 6000	NPT F x BSPT M, BSPT F x NPT M	N8508
1-1/4" x 3/4"	32 x 20	42.2 x 26.7	Class 3000 / 6000	NPT F x BSPT M, BSPT F x NPT M	N8509
1-1/4" x 1"	32 x 25	42.2 x 33.4	Class 3000 / 6000	NPT F x BSPT M, BSPT F x NPT M	N8510
1-1/4" x 1-1/4"	32 x 32	42.2 x 42.2	Class 3000 / 6000	NPT F x BSPT M, BSPT F x NPT M	N8511
1-1/2" x 1/2"	40 x 15	48.3 x 21.3	Class 3000 / 6000	NPT F x BSPT M, BSPT F x NPT M	N8512
1-1/2" x 3/4"	40 x 20	48.3 x 26.7	Class 3000 / 6000	NPT F x BSPT M, BSPT F x NPT M	N8513
1-1/2" x 1"	40 x 25	48.3 x 33.4	Class 3000 / 6000	NPT F x BSPT M, BSPT F x NPT M	N8514
1-1/2" x 1-1/4"	40 x 32	48.3 x 42.2	Class 3000 / 6000	NPT F x BSPT M, BSPT F x NPT M	N8515
1-1/2" x 1-1/2"	40 x 40	48.3 x 48.3	Class 3000 / 6000	NPT F x BSPT M, BSPT F x NPT M	N8516

NPT x BSPT threaded female and male adaptor

Available size

Size			Working pressure	Connection	Ref. No.
NPS	DN	OD (mm)			
2" x 1/2"	50 x 15	60.3 x 21.3	Class 3000 / 6000	NPT F x BSPT M, BSPT F x NPT M	N8517
2" x 3/4"	50 x 20	60.3 x 26.7	Class 3000 / 6000	NPT F x BSPT M, BSPT F x NPT M	N8518
2" x 1"	50 x 25	60.3 x 33.4	Class 3000 / 6000	NPT F x BSPT M, BSPT F x NPT M	N8519
2" x 1-1/4"	50 x 32	60.3 x 42.2	Class 3000 / 6000	NPT F x BSPT M, BSPT F x NPT M	N8520
2" x 1-1/2"	50 x 40	60.3 x 48.3	Class 3000 / 6000	NPT F x BSPT M, BSPT F x NPT M	N8521
2" x 2"	50 x 50	60.3 x 60.3	Class 3000 / 6000	NPT F x BSPT M, BSPT F x NPT M	N8522
2-1/2" x 1/2"	65 x 15	73.0 (76.1) x 21.3	Class 3000 / 6000	NPT F x BSPT M, BSPT F x NPT M	N8523
2-1/2" x 3/4"	65 x 20	73.0 (76.1) x 26.7	Class 3000 / 6000	NPT F x BSPT M, BSPT F x NPT M	N8524
2-1/2" x 1"	65 x 25	73.0 (76.1) x 33.4	Class 3000 / 6000	NPT F x BSPT M, BSPT F x NPT M	N8525
2-1/2" x 1-1/4"	65 x 32	73.0 (76.1) x 42.2	Class 3000 / 6000	NPT F x BSPT M, BSPT F x NPT M	N8526
2-1/2" x 1-1/2"	65 x 40	73.0 (76.1) x 48.3	Class 3000 / 6000	NPT F x BSPT M, BSPT F x NPT M	N8527
2-1/2" x 2"	65 x 50	73.0 (76.1) x 60.3	Class 3000 / 6000	NPT F x BSPT M, BSPT F x NPT M	N8528
2-1/2" x 2-1/2"	65 x 65	73.0 (76.1) x 73.0 (76.1)	Class 3000 / 6000	NPT F x BSPT M, BSPT F x NPT M	N8529
3" x 1/2"	80 x 15	88.9 x 21.3	Class 3000 / 6000	NPT F x BSPT M, BSPT F x NPT M	N8530
3" x 3/4"	80 x 20	88.9 x 26.7	Class 3000 / 6000	NPT F x BSPT M, BSPT F x NPT M	N8531
3" x 1"	80 x 25	88.9 x 33.4	Class 3000 / 6000	NPT F x BSPT M, BSPT F x NPT M	N8532
3" x 1-1/4"	80 x 32	88.9 x 42.2	Class 3000 / 6000	NPT F x BSPT M, BSPT F x NPT M	N8533
3" x 1-1/2"	80 x 40	88.9 x 48.3	Class 3000 / 6000	NPT F x BSPT M, BSPT F x NPT M	N8534
3" x 2"	80 x 50	88.9 x 60.3	Class 3000 / 6000	NPT F x BSPT M, BSPT F x NPT M	N8535
3" x 2-1/2"	80 x 65	88.9 x 73.0 (76.1)	Class 3000 / 6000	NPT F x BSPT M, BSPT F x NPT M	N8536
3" x 3"	80 x 80	88.9 x 88.9	Class 3000 / 6000	NPT F x BSPT M, BSPT F x NPT M	N8537
4" x 1/2"	100 x 15	114.3 x 21.3	Class 3000 / 6000	NPT F x BSPT M, BSPT F x NPT M	N8538
4" x 3/4"	100 x 20	114.3 x 26.7	Class 3000 / 6000	NPT F x BSPT M, BSPT F x NPT M	N8539
4" x 1"	100 x 25	114.3 x 33.4	Class 3000 / 6000	NPT F x BSPT M, BSPT F x NPT M	N8540
4" x 1-1/4"	100 x 32	114.3 x 42.2	Class 3000 / 6000	NPT F x BSPT M, BSPT F x NPT M	N8541
4" x 1-1/2"	100 x 40	114.3 x 48.3	Class 3000 / 6000	NPT F x BSPT M, BSPT F x NPT M	N8542
4" x 2"	100 x 50	114.3 x 60.3	Class 3000 / 6000	NPT F x BSPT M, BSPT F x NPT M	N8543
4" x 2-1/2"	100 x 65	114.3 x 73.0 (76.1)	Class 3000 / 6000	NPT F x BSPT M, BSPT F x NPT M	N8544
4" x 3"	100 x 80	114.3 x 88.9	Class 3000 / 6000	NPT F x BSPT M, BSPT F x NPT M	N8545
4" x 4"	100 x 100	114.3 x 114.3	Class 3000 / 6000	NPT F x BSPT M, BSPT F x NPT M	N8546