

# Shotgun riser check valve

Shotgun riser check valve is swing type check valve with a drain and two pressure gauges connection. With compact configuration, it prevents backflow, tests the riser, and may replace alarm check valve when no need water motor alarm.

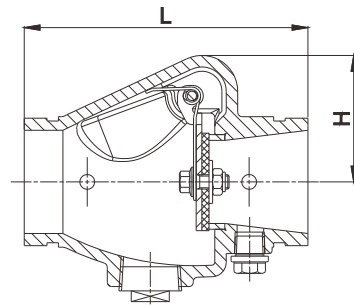

- Certificate: UL Listed / FM Approved
- Standard: UL 312, FM 1210
- Connection: Grooved as AWWA C606
- Temperature: 0°C to 87°C
- W. pressure: 300 psi
- Surface: FBE coating as AWWA C550



## Main parts and feature

<b>Check valve body</b>	Ductile iron as ASTM A536, 65-45-12	<b>Disc</b>	Stainless steel 304
<b>Standard Accessories</b>	Close nipple, 1/4" nipple, plug	<b>Pre-assembly components</b>	Angle drain valve x 1, 3-way valve x 2, gauge x 2

## Available size

Size		L	H	Plug NPT	Working pressure (psi)	Ref. No.
Inch	DN	mm	mm			
1-1/4"	32	160	65	1/2"	300	V7301
1-1/2"	40	160	65	1/2"	300	V7302
2"	50	170	75	1/2"	300	V7303
2-1/2"	65	183	80	1/2"	300	V7304
3"	80	198	90	1/2"	300	V7305
4"	100	218	102	1/2"	300	V7306
6"	150	270	127	1/2"	300	V7307
8"	200	325	160	1/2"	300	V7308