

Hubbed slip-on flange

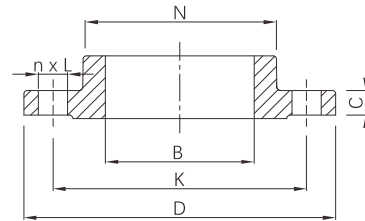

- Certificate: ISO
- Standard: EN 1092-1 Type 12, GB/T 9124.1
- Material: Forged carbon steel EN 10025-2 S235JR
Forged SS equivalent to F304 / F316L
- Flange facing: FF / RF
- Pressure rating: PN 16 / PN 10 / PN 25, etc.
- Surface: Oiled / hot dip galvanized
Pickling white, etc.



Available size of PN 16

Size			Rating class	Flange OD D (mm)	Bolt circle dia. K (mm)	Bolting (No.x hole)	Ref. weight (kg)	Ref. No.
NPS	DN	OD (mm)						
1/2"	15	21.3	PN 16	95	65	4 x 14	0.72	NE4201-PN16
3/4"	20	26.9	PN 16	105	75	4 x 14	1.04	NE4202-PN16
1"	25	33.7	PN 16	115	85	4 x 14	1.25	NE4203-PN16
1-1/4"	32	42.4	PN 16	140	100	4 x 18	1.81	NE4204-PN16
1-1/2"	40	48.3	PN 16	150	110	4 x 18	2.06	NE4205-PN16
2"	50	60.3	PN 16	165	125	4 x 18	2.39	NE4206-PN16
2-1/2"	65	73.0 / 76.1	PN 16	185	145	8 (4) x 18*	2.97	NE4207-PN16
3"	80	88.9	PN 16	200	160	8 x 18	3.78	NE4208-PN16
4"	100	114.3	PN 16	220	180	8 x 18	4.38	NE4209-PN16
5"	125	139.7	PN 16	250	210	8 x 18	6.07	NE4210-PN16
6"	150	165.1 / 168.3	PN 16	285	240	8 x 22	7.24	NE4211-PN16
8"	200	219.1	PN 16	340	295	12 x 22	9.80	NE4212-PN16
10"	250	273.0	PN 16	405	355	12 x 26	13.6	NE4213-PN16
12"	300	323.9	PN 16	460	410	12 x 26	17.2	NE4214-PN16
14"	350	355.6	PN 16	520	470	16 x 26	27.9	NE4215-PN16
16"	400	406.4	PN 16	580	525	16 x 30	35.7	NE4216-PN16
18"	450	457	PN 16	640	585	20 x 30	45.0	NE4217-PN16
20"	500	508	PN 16	715	650	20 x 33	60.4	NE4218-PN16
24"	600	610	PN 16	840	770	20 x 36	94.0	NE4219-PN16

Note: * Size DN 65 with PN 16 / PN 10 can also be supplied with 4 holes, to match EN 1092-2 (Cast iron flange) and EN 1092-3 (Copper alloy flange) connection.

Hubbed slip-on flange

Available size of PN 10

Size			Rating class	Flange OD D (mm)	Bolt circle dia. K (mm)	Bolting (No.x hole)	Ref. weight (kg)	Ref. No.
NPS	DN	OD (mm)						
1/2"	15	21.3	PN 10	95	65	4 x 14	0.72	NE4201-PN10
3/4"	20	26.9	PN 10	105	75	4 x 14	1.04	NE4202-PN10
1"	25	33.7	PN 10	115	85	4 x 14	1.25	NE4203-PN10
1-1/4"	32	42.4	PN 10	140	100	4 x 18	1.81	NE4204-PN10
1-1/2"	40	48.3	PN 10	150	110	4 x 18	2.06	NE4205-PN10
2"	50	60.3	PN 10	165	125	4 x 18	2.39	NE4206-PN10
2-1/2"	65	73.0 / 76.1	PN 10	185	145	8 (4) x 18*	2.97	NE4207-PN10
3"	80	88.9	PN 10	200	160	8 x 18	3.78	NE4208-PN10
4"	100	114.3	PN 10	220	180	8 x 18	4.38	NE4209-PN10
5"	125	139.7	PN 10	250	210	8 x 18	6.07	NE4210-PN10
6"	150	165.1 / 168.3	PN 10	285	240	8 x 22	7.24	NE4211-PN10
8"	200	219.1	PN 10	340	295	8 x 22	10.1	NE4212-PN10
10"	250	273.0	PN 10	395	350	12 x 22	12.8	NE4213-PN10
12"	300	323.9	PN 10	445	400	12 x 22	14.5	NE4214-PN10
14"	350	355.6	PN 10	505	460	16 x 22	22.7	NE4215-PN10
16"	400	406.4	PN 10	565	515	16 x 26	28.0	NE4216-PN10
18"	450	457	PN 10	615	565	20 x 26	32.3	NE4217-PN10
20"	500	508	PN 10	670	620	20 x 26	38.7	NE4218-PN10
24"	600	610	PN 10	780	725	20 x 30	48.9	NE4219-PN10

Available size of PN 25

Size			Rating class	Flange OD D (mm)	Bolt circle dia. K (mm)	Bolting (No.x hole)	Ref. weight (kg)	Ref. No.
NPS	DN	OD (mm)						
1/2"	15	21.3	PN 25	95	65	4 x 14	0.72	NE4201-PN25
3/4"	20	26.9	PN 25	105	75	4 x 14	1.04	NE4202-PN25
1"	25	33.7	PN 25	115	85	4 x 14	1.25	NE4203-PN25
1-1/4"	32	42.4	PN 25	140	100	4 x 18	1.81	NE4204-PN25
1-1/2"	40	48.3	PN 25	150	110	4 x 18	2.06	NE4205-PN25
2"	50	60.3	PN 25	165	125	4 x 18	2.74	NE4206-PN25
2-1/2"	65	73.0 / 76.1	PN 25	185	145	8 x 18	3.65	NE4207-PN25
3"	80	88.9	PN 25	200	160	8 x 18	4.59	NE4208-PN25
4"	100	114.3	PN 25	235	190	8 x 22	6.10	NE4209-PN25
5"	125	139.7	PN 25	270	220	8 x 26	8.22	NE4210-PN25
6"	150	165.1 / 168.3	PN 25	300	250	8 x 26	10.6	NE4211-PN25
8"	200	219.1	PN 25	360	310	12 x 26	14.9	NE4212-PN25
10"	250	273.0	PN 25	425	370	12 x 30	20.9	NE4213-PN25
12"	300	323.9	PN 25	485	430	16 x 30	27.3	NE4214-PN25
14"	350	355.6	PN 25	555	490	16 x 33	45.1	NE4215-PN25
16"	400	406.4	PN 25	620	550	16 x 36	57.7	NE4216-PN25
18"	450	457	PN 25	670	600	20 x 36	69.6	NE4217-PN25
20"	500	508	PN 25	730	660	20 x 36	87.0	NE4218-PN25
24"	600	610	PN 25	845	770	20 x 39	111	NE4219-PN25