

## Equal half socket (Medium and heavy type)

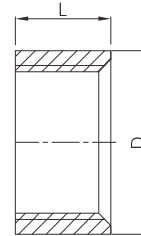

- Certificate: ISO
- Standard: EN 10241
- Material: As medium or heavy series tube
- Thread: BSPP / BSPT / NPT
- Hydro test: Min 50 bar
- Surface: Oiled / hot dip galvanized



### Available size for medium series

Size			Thickness type	Min OD	Overall length	Ref. No.
NPS	DN	OD (mm)		D (mm)	L (mm)	
1/2"	15	21.3	Medium	26.6	15	NE2501
3/4"	20	26.9	Medium	31.8	17	NE2502
1"	25	33.7	Medium	39.5	20	NE2503
1-1/4"	32	42.4	Medium	48.3	22	NE2504
1-1/2"	40	48.3	Medium	54.5	22	NE2505
2"	50	60.3	Medium	68.0	26	NE2506
2-1/2"	65	76.1	Medium	84.2	30	NE2507
3"	80	88.9	Medium	98.4	34	NE2508
4"	100	114.3	Medium	124.0	40	NE2509
5"	125	139.7	Medium	149.0	44	NE2510
6"	150	165.1 / 168.3	Medium	177.0	44	NE2511

**Note:**

1. The internal thread shall be parallel BSPP as standard, but BSPT and NPT are also available.
2. Other length is available as customer request.

## Equal half socket (Medium and heavy type)

### Available size for heavy series

Size			Thickness type	Min OD	Overall length	Ref. No.
NPS	DN	OD (mm)		D (mm)	L (mm)	
1/2"	15	21.3	Heavy	27.0	16	NE2521
3/4"	20	26.9	Heavy	32.5	19	NE2522
1"	25	33.7	Heavy	39.5	21	NE2523
1-1/4"	32	42.4	Heavy	49.0	25	NE2524
1-1/2"	40	48.3	Heavy	56.0	25	NE2525
2"	50	60.3	Heavy	68.0	28	NE2526
2-1/2"	65	76.1	Heavy	84.0	30	NE2527
3"	80	88.9	Heavy	98.0	35	NE2528
4"	100	114.3	Heavy	124.0	40	NE2529
5"	125	139.7	Heavy	151.0	44	NE2530
6"	150	165.1 / 168.3	Heavy	177.0	44	NE2531

**Note:**

1. The internal thread shall be parallel BSPP as standard, but BSPT and NPT are also available.
2. Other length is available as customer request.