

Threaded flange

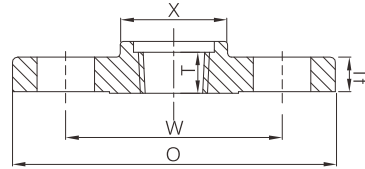

- Certificate: ISO
- Standard: ASME B16.5, GB/T 9124.2
- Material: Forged carbon steel ASTM A105
Forged SS ASTM A182, F304 / F316L
- Flange facing: RF
- Thread: NPT thread as ASME B1.20.1
- Rated pressure: Class 150 / 300, etc.
- Surface: Oiled / hot dip galvanized
Pickling white, etc.



Available size (Class 150)

Size			Rating class	Flange OD O (mm)	Bolt circle dia. W (mm)	Bolting (No. x hole)	Ref. weight (kg)	Ref. No.
NPS	DN	OD (mm)						
1/2"	15	21.3	Class 150	90	60.3	4 x 5/8"	0.42	N8901-150
3/4"	20	26.7	Class 150	100	69.9	4 x 5/8"	0.61	N8902-150
1"	25	33.4	Class 150	110	79.4	4 x 5/8"	0.84	N8903-150
1-1/4"	32	42.2	Class 150	115	88.9	4 x 5/8"	1.02	N8904-150
1-1/2"	40	48.3	Class 150	125	98.4	4 x 5/8"	1.33	N8905-150
2"	50	60.3	Class 150	150	120.7	4 x 3/4"	2.08	N8906-150
2-1/2"	65	73.0 / 76.1	Class 150	180	139.7	4 x 3/4"	3.54	N8907-150
3"	80	88.9	Class 150	190	152.4	4 x 3/4"	4.05	N8908-150
4"	100	114.3	Class 150	230	190.5	8 x 3/4"	5.70	N8909-150
5"	125	139.7	Class 150	255	215.9	8 x 7/8"	6.61	N8910-150
6"	150	165.1 / 168.3	Class 150	280	241.3	8 x 7/8"	8.14	N8911-150
8"	200	219.1	Class 150	345	298.5	8 x 7/8"	13.2	N8912-150
10"	250	273.0	Class 150	405	362.0	12 x 1"	17.7	N8913-150
12"	300	323.8	Class 150	485	431.8	12 x 1"	28.4	N8914-150
14"	350	355.6	Class 150	535	476.3	12 x 1-1/8"	37.5	N8915-150
16"	400	406.4	Class 150	595	539.8	16 x 1-1/8"	47.6	N8916-150
18"	450	457	Class 150	635	577.9	16 x 1-1/4"	53.0	N8917-150
20"	500	508	Class 150	700	635.0	20 x 1-1/4"	67.3	N8918-150
24"	600	610	Class 150	815	749.3	20 x 1-3/8"	95.4	N8919-150

Threaded flange

Available size (Class 300)

Size			Rating class	Flange OD O (mm)	Bolt circle dia. W (mm)	Bolting (No. x hole)	Ref. weight (kg)	Ref. No.
NPS	DN	OD (mm)						
1/2"	15	21.3	Class 300	95	66.7	4 x 5/8"	0.65	N8901-300
3/4"	20	26.7	Class 300	115	82.6	4 x 3/4"	1.09	N8902-300
1"	25	33.4	Class 300	125	88.9	4 x 3/4"	1.41	N8903-300
1-1/4"	32	42.2	Class 300	135	98.4	4 x 3/4"	1.77	N8904-300
1-1/2"	40	48.3	Class 300	155	114.3	4 x 7/8"	2.54	N8905-300
2"	50	60.3	Class 300	165	127.0	8 x 3/4"	2.97	N8906-300
2-1/2"	65	73.0 / 76.1	Class 300	190	149.2	8 x 7/8"	4.48	N8907-300
3"	80	88.9	Class 300	210	168.3	8 x 7/8"	6.06	N8908-300
4"	100	114.3	Class 300	255	200.0	8 x 7/8"	10.0	N8909-300
5"	125	139.7	Class 300	280	235.0	8 x 7/8"	12.8	N8910-300
6"	150	165.1 / 168.3	Class 300	320	269.9	12 x 7/8"	16.7	N8911-300
8"	200	219.1	Class 300	380	330.2	12 x 1"	24.8	N8912-300
10"	250	273.0	Class 300	445	387.4	16 x 1-1/8"	35.7	N8913-300
12"	300	323.8	Class 300	520	450.8	16 x 1-1/4"	51.5	N8914-300
14"	350	355.6	Class 300	585	514.4	20 x 1-1/4"	72.5	N8915-300
16"	400	406.4	Class 300	650	571.5	20 x 1-3/8"	92.7	N8916-300
18"	450	457	Class 300	710	628.6	24 x 1-3/8"	111.9	N8917-300
20"	500	508	Class 300	775	685.8	24 x 1-3/8"	139.6	N8918-300
24"	600	610	Class 300	915	812.8	24 x 1-5/8"	209.4	N8919-300