

Threaded pipe coupling (Merchant coupling)

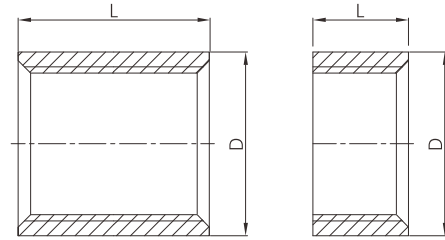

- Certificate: ISO
- Standard: ASTM A865, ASTM A589
- Material: ASTM A865, seamless or welded
- Thread: NPSC / NPT / BSPT for full or half thread
- Type: For STD pipe, XS pipe, XXS pipe
- Surface: Black / galvanized



Available size

Size			Thickness range		D (mm)	Length type	Ref. No.
NPS	DN	OD (mm)	Sch 40 (STD)	Sch80 (XS)			
1/2"	15	21.3	2.77	3.73	27.0	Full / half	N6401
3/4"	20	26.7	2.87	3.91	33.4	Full / half	N6402
1"	25	33.4	3.38	4.55	40.0	Full / half	N6403
1-1/4"	32	42.2	3.56	4.85	48.3	Full / half	N6404
1-1/2"	40	48.3	3.68	5.08	55.9	Full / half	N6405
2"	50	60.3	3.91	5.54	69.8	Full / half	N6406
2-1/2"	65	73.0	5.16	7.01	82.5	Full / half	N6407
3"	80	88.9	5.49	7.62	101.6	Full / half	N6408
4"	100	114.3	6.02	8.56	127.0	Full / half	N6409
5"	125	141.3	6.55	9.53	159.9	Full / half	N6410
6"	150	168.3	7.11	10.97	187.7	Full / half	N6411

Note:

1. For half coupling, the unthreaded end is square cut.
2. For size up to 2" (DN 50), the coupling is normally supplied with straight tapped NPSC.
3. Other thickness and length is available as customer request.