

Threaded hex head bushing

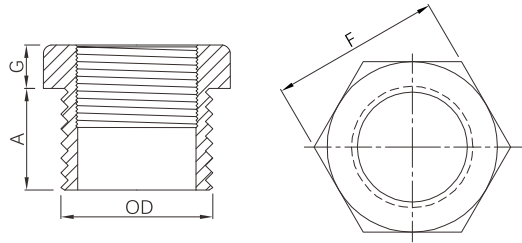

- Certificate: ISO
- Standard: ASME B16.11
- Material: Forged carbon steel ASTM A105
Forged SS ASTM A182, F304 / F316L
- Thread: NPT / BSPT, large end M x small end F
- W. pressure: ≤ Class 6000
- Surface: Oiled / hot dip galvanized
Pickling white, etc.



Available size

NPS	Size		Min length	Min hex height	Min width flats	Ref. No.
	DN	OD (mm)	A (mm)	G (mm)	F (mm)	
1/2" x 3/8"	15 x 10	21.3 x 17.1	14	5	22.23	N5701
3/4" x 1/2"	20 x 15	26.7 x 21.3	16	6	26.99	N5702
1" x 1/2"	25 x 15	33.4 x 21.3	19	6	34.93	N5703
1" x 3/4"	25 x 20	33.4 x 26.7	19	6	34.93	N5704
1-1/4" x 1/2"	32 x 15	42.2 x 21.3	21	7	44.45	N5705
1-1/4" x 3/4"	32 x 20	42.2 x 26.7	21	7	44.45	N5706
1-1/4" x 1"	32 x 25	42.2 x 33.4	21	7	44.45	N5707
1-1/2" x 1/2"	40 x 15	48.3 x 21.3	21	8	50.80	N5708
1-1/2" x 3/4"	40 x 20	48.3 x 26.7	21	8	50.80	N5709
1-1/2" x 1"	40 x 25	48.3 x 33.4	21	8	50.80	N5710
1-1/2" x 1-1/4"	40 x 32	48.3 x 42.2	21	8	50.80	N5711
2" x 1/2"	50 x 15	60.3 x 21.3	22	9	63.50	N5712
2" x 3/4"	50 x 20	60.3 x 26.7	22	9	63.50	N5713
2" x 1"	50 x 25	60.3 x 33.4	22	9	63.50	N5714
2" x 1-1/4"	50 x 32	60.3 x 42.2	22	9	63.50	N5715
2" x 1-1/2"	50 x 40	60.3 x 48.3	22	9	63.50	N5716

Threaded hex head bushing

Available size

Size			Min length	Min hex height	Min width flats	Ref. No.
NPS	DN	OD (mm)	A (mm)	G (mm)	F (mm)	
2-1/2" x 1/2"	65 x 15	73.0 x 21.3	27	10	76.20	N5717
2-1/2" x 3/4"	65 x 20	73.0 x 26.7	27	10	76.20	N5718
2-1/2" x 1"	65 x 25	73.0 x 33.4	27	10	76.20	N5719
2-1/2" x 1-1/4"	65 x 32	73.0 x 42.2	27	10	76.20	N5720
2-1/2" x 1-1/2"	65 x 40	73.0 x 48.3	27	10	76.20	N5721
2-1/2" x 2"	65 x 50	73.0 x 60.3	27	10	76.20	N5722
3" x 1/2"	80 x 15	88.9 x 21.3	28	10	88.90	N5723
3" x 3/4"	80 x 20	88.9 x 26.7	28	10	88.90	N5724
3" x 1"	80 x 25	88.9 x 33.4	28	10	88.90	N5725
3" x 1-1/4"	80 x 32	88.9 x 42.2	28	10	88.90	N5726
3" x 1-1/2"	80 x 40	88.9 x 48.3	28	10	88.90	N5727
3" x 2"	80 x 50	88.9 x 60.3	28	10	88.90	N5728
3" x 2-1/2"	80 x 65	88.9 x 73.0	28	10	88.90	N5729
4" x 1/2"	100 x 15	114.3 x 21.3	32	13	117.48	N5730
4" x 3/4"	100 x 20	114.3 x 26.7	32	13	117.48	N5731
4" x 1"	100 x 25	114.3 x 33.4	32	13	117.48	N5732
4" x 1-1/4"	100 x 32	114.3 x 42.2	32	13	117.48	N5733
4" x 1-1/2"	100 x 40	114.3 x 48.3	32	13	117.48	N5734
4" x 2"	100 x 50	114.3 x 60.3	32	13	117.48	N5735
4" x 2-1/2"	100 x 65	114.3 x 73.0	32	13	117.48	N5736
4" x 3"	100 x 80	114.3 x 88.9	32	13	117.48	N5737

Note: Bushings are not identified by class designation, and they may be used for ratings up to Class 6000 designation.