

## Butt weld 45° elbow (Long radius)

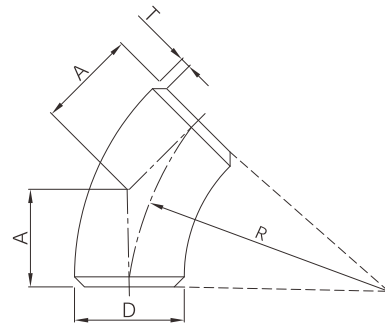

- Certificate: ISO
- Standard: ASME B16.9
- Material: Carbon steel ASTM A234, WPB  
SS ASTM A403, WP304 / WP316L
- Type: Long radius, R=1.5D
- W. pressure: Equal to same seamless pipe
- Surface: Black painting / hot dip galvanized  
Pickling white, etc.



### Available size

Size			Thickness (mm)			A (mm)	Ref. No.
NPS	DN	OD (mm)	Sch10	Sch40	Sch80		
1/2"	15	21.3	2.11	2.77	3.73	16	N0301
3/4"	20	26.7	2.11	2.87	3.91	19	N0302
1"	25	33.4	2.77	3.38	4.55	22	N0303
1-1/4"	32	42.2	2.77	3.56	4.85	25	N0304
1-1/2"	40	48.3	2.77	3.68	5.08	29	N0305
2"	50	60.3	2.77	3.91	5.54	35	N0306
2-1/2"	65	73.0	3.05	5.16	7.01	44	N0307
3"	80	88.9	3.05	5.49	7.62	51	N0308
4"	100	114.3	3.05	6.02	8.56	64	N0309
5"	125	141.3	3.40	6.55	9.53	79	N0310
6"	150	168.3	3.40	7.11	10.97	95	N0311
8"	200	219.1	3.76	8.18	12.70	127	N0312
10"	250	273.0	4.19	9.27	15.09	159	N0313
12"	300	323.8	4.57	10.31	17.48	190	N0314
14"	350	355.6	6.35	11.13	19.05	222	N0315
16"	400	406.4	6.35	12.70	21.44	254	N0316
18"	450	457	6.35	14.27	23.83	286	N0317
20"	500	508	6.35	15.09	26.19	318	N0318
24"	600	610	6.35	17.48	30.96	381	N0319

**Note:** The thickness is available with Sch5, Sch10, Sch30, Sch40, Sch80, Sch120, Sch160, STD, XS, XXS, 5S, 10S, 40S, 80S, etc.