

Malleable iron 45° street elbow

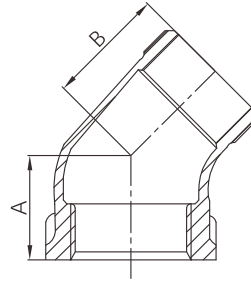

- Certificate: UL Listed / FM Approved
- Standard: ASME B16.3
- Material: Malleable iron ASTM A197
- Thread: NPT
- W. pressure: Class 150, 300 psi (-29°C to 66°C)
Class 300, 1000 / 1500 / 2000 psi (-29°C to 66°C)
- Surface: Black iron / hot dip galvanized



Available size (Class 150)

Inch	Size		A mm	B mm	Ref. No.
	DN	mm			
1/2"	15	21.3	22.4	29.2	M5603 (UL/FM)
3/4"	20	26.7	24.9	32.8	M5604 (UL/FM)
1"	25	33.4	28.5	37.3	M5605 (UL/FM)
1-1/4"	32	42.2	32.8	43.4	M5606 (UL/FM)
1-1/2"	40	48.3	36.3	47.8	M5607 (UL/FM)
2"	50	60.3	42.7	56.4	M5608 (UL/FM)
2-1/2"	65	73.0	49.5	65.3	M5609 (UL/FM)
3"	80	88.9	55.1	76.2	M5610 (UL/FM)
4"	100	114.3	66.3	94.0	M5611 (UL/FM)

Malleable iron 45° street elbow

Available size (Class 300)

Size			A	B	Ref. No.
Inch	DN	mm	mm	mm	
3/4"	20	26.7	28.7	39.6	M5604-300 (ISO)
1"	25	33.4	33.3	46.0	M5605-300 (ISO)
1-1/4"	32	42.2	38.1	54.1	M5606-300 (ISO)
1-1/2"	40	48.3	42.9	58.7	M5607-300 (ISO)