

# Malleable cast iron hexagon nipple

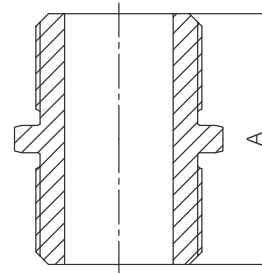

- Certificate: UL Listed / FM Approved / NSF 61
- Standard: ISO 49 / EN 10242, symbol C
- Material: BS EN 1562, EN-GJMB-350-10
- Thread: BSPT
- W. pressure: 20 ~ 25 bar, ≤ PN25
- Surface: Black iron / hot dip galvanized



## Available size

| Inch   | Size |       | A   | Ref. No.      |
|--------|------|-------|-----|---------------|
|        | DN   | mm    | mm  |               |
| 1/4"   | 8    | 13.5  | 36  | M3001 (UL/FM) |
| 3/8"   | 10   | 17.2  | 38  | M3002 (UL/FM) |
| 1/2"   | 15   | 21.3  | 44  | M3003 (UL/FM) |
| 3/4"   | 20   | 26.9  | 47  | M3004 (UL/FM) |
| 1"     | 25   | 33.7  | 53  | M3005 (UL/FM) |
| 1-1/4" | 32   | 42.4  | 57  | M3006 (UL/FM) |
| 1-1/2" | 40   | 48.3  | 59  | M3007 (UL/FM) |
| 2"     | 50   | 60.3  | 68  | M3008 (UL/FM) |
| 2-1/2" | 65   | 76.1  | 75  | M3009 (UL/FM) |
| 3"     | 80   | 88.9  | 83  | M3010 (UL/FM) |
| 4"     | 100  | 114.3 | 95  | M3011 (UL/FM) |
| 6"     | 150  | 165.1 | 114 | M3013 (UL/FM) |

**Note:** NSF 61 certificate is available for M3003 ~ M3011, except M3001, M3002, M3013.