

Malleable cast iron socket (Coupling)

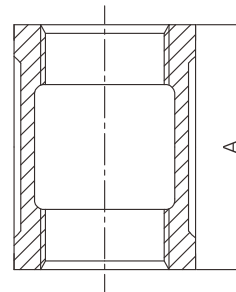

- Certificate: UL Listed / FM Approved / NSF 61
- Standard: ISO 49 / EN 10242, symbol C
- Material: BS EN 1562, EN-GJMB-350-10
- Thread: BSPT
- W. pressure: 20 ~ 25 bar, ≤ PN25
- Surface: Black iron / hot dip galvanized



Available size

Size			A	Thread Length	Ref. No.
Inch	DN	mm	mm		
1/4"	8	13.5	27	Double ends / Full length	M2301 (UL)
3/8"	10	17.2	30	Double ends / Full length	M2302 (UL)
1/2"	15	21.3	36	Double ends / Full length	M2303 (UL/FM)
3/4"	20	26.9	39	Double ends / Full length	M2304 (UL/FM)
1"	25	33.7	45	Double ends / Full length	M2305 (UL/FM)
1-1/4"	32	42.4	50	Double ends / Full length	M2306 (UL/FM)
1-1/2"	40	48.3	55	Double ends / Full length	M2307 (UL/FM)
2"	50	60.3	65	Double ends / Full length	M2308 (UL/FM)
2-1/2"	65	76.1	74	Double ends / Full length	M2309 (UL/FM)
3"	80	88.9	80	Double ends / Full length	M2310 (UL/FM)
4"	100	114.3	94	Double ends / Full length	M2311 (UL/FM)
6"	150	165.1	105	Double ends / Full length	M2313 (UL/FM)

Note: NSF 61 certificate is available for M2301, M2302, M2313.