

Plain end HDPE coupling

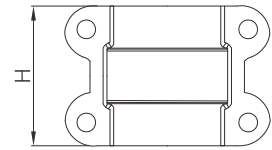

- Certificate: ISO
- Standard: Refer to ANSI / UL 213
- Housing: Ductile iron ASTM A536, 65-45-12
- Bolt & nut: Carbon steel, detail as G92 ~ G96
- Gasket: EPDM, nitrile, silicone rubber, etc.
- Rated pressure: 300 ~ 500 psi
- Surface: Red painting / hot dip galvanized

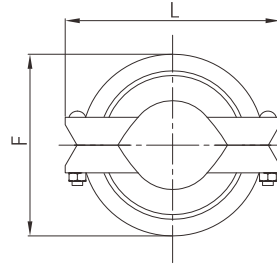

Available size

Size			Dimension (mm)			Bolting (n x bolt size)		Ref. No.
Inch	DN	mm	F	L	H	ANSI	EN	
2"	50	60.3	83	120	116	4 - 1/2" x 60	4 - M12 x 60	G5901
/	/	63.0	89	116	105	4 - 3/8" x 55	4 - M10 x 55	G5902
3"	80	88.9	114	166	118	4 - 1/2" x 75	4 - M12 x 75	G5903
/	/	110.0	137	180	110	4 - 1/2" x 75	4 - M12 x 75	G5904
4"	100	114.0	143	201	147	4 - 1/2" x 75	4 - M12 x 75	G5905
/	/	160.0	188	235	118	4 - 1/2" x 75	4 - M12 x 75	G5906
6"	150	168.3	202	252	150	4 - 5/8" x 85	4 - M16 x 85	G5907
8"	200	219.1	258	320	152	4 - 5/8" x 85	4 - M16 x 85	G5908
/	/	251.5	288	350	141	4 - 3/4" x 110	4 - M16 x 100	G5909
10"	250	273.0	313	390	165	4 - 3/4" x 110	4 - M20 x 100	G5910
12"	300	323.9	367	455	183	4 - 3/4" x 120	4 - M20 x 120	G5911