

## EN grooved flange two-piece (Flanged adapter)

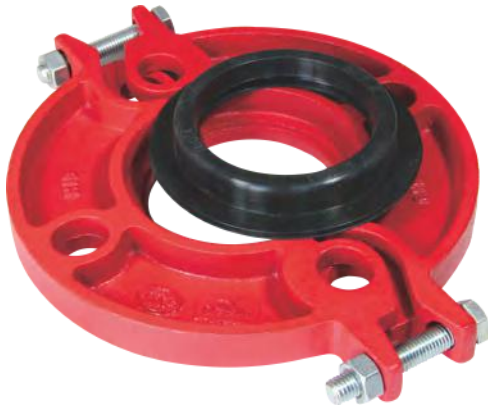

- Certificate: UL Listed / FM Approved
- Standard: ANSI / UL 213
- Housing: Ductile iron ASTM A536, 65-45-12
- Bolt & nut: Carbon steel, detail as G92 ~ G96
- Gasket: EPDM, nitrile, silicone rubber, etc.
- Mating flange: EN 1092-2, PN 16, FF, RF, MF, etc.
- Rated pressure: 300 ~ 500 psi
- Surface: Red painting / hot dip galvanized

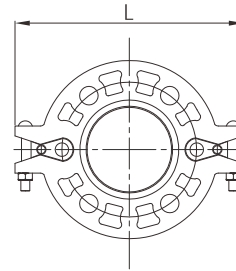

### Available size of PN16

Size			L mm	Assembly bolting (n - shank bolt)	Bolting for mating flange		Flanged end connection	Ref. No.
Inch	DN	mm			PCD (mm)	Bolt		
1-1/2"	40	48.3	195	2 - M10 x 50	110	4 x M16	PN 16	G4603-16 (UL/FM)
2"	50	60.3	220	2 - M10 x 50	125	4 x M16	PN 16	G4604-16 (UL/FM)
2-1/2"	65	76.1	235	2 - M10 x 50	145	4 x M16	PN 16	G4606-16 (UL/FM)
3"	80	88.9	255	2 - M10 x 50	160	8 x M16	PN 16	G4607-16 (UL/FM)
4"	100	114.3	279	2 - M10 x 50	180	8 x M16	PN 16	G4608-16 (UL/FM)
5"	125	139.7	320	2 - M12 x 65	210	8 x M16	PN 16	G4609-16 (UL/FM)
6"	150	165.1	346	2 - M12 x 65	240	8 x M20	PN 16	G4611-16 (UL/FM)
6"	150	168.3	346	2 - M12 x 65	240	8 x M20	PN 16	G4612-16 (UL/FM)
8"	200	219.1	414.3	2- M10 x 70	295	12 x M20	PN 16	G4613-16 (UL/FM)
10"	250	273.0	480	2- M10 x 70	355	12 x M24	PN 16	G4614-16 (UL/FM)
12"	300	323.9	530.5	2- M10 x 70	410	12 x M24	PN 16	G4615-16 (UL/FM)
14"	350	355.6	580.0	/	470	16 x M24	PN 16	G4616-16 (UL)

## EN grooved flange two-piece (Flanged adapter)

### Available size of PN25

Size			L mm	Assembly bolting (n - shank bolt)	Bolting for mating flange		Flanged end connection	Ref. No.
Inch	DN	mm			PCD (mm)	Bolt		
4"	100	114.3	279	2 - M10 x 50	180	8 x M16	PN 25	G4608-25 (ISO)
6"	150	165.1	346	2 - M12 x 65	240	8 x M20	PN 25	G4611-25 (UL)