

# Grooved concentric reducer with male threaded outlet

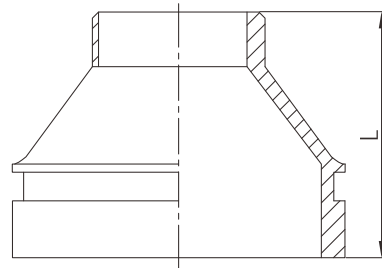

- Certificate: UL Listed / FM Approved
- Standard: ANSI / UL 213C
- Material: Ductile iron ASTM A536, 65-45-12
- Thread run: Male thread, NPT / BSPT
- Rated pressure: 300 ~ 500 psi
- Surface: Red painting / hot dip galvanized



## Available size

Inch	Size		End to end L (mm)	Ref. No.
	DN	mm		
2" x 1"	50 x 25	60.3 x 33.7	64	G3401
2" x 1-1/4"	50 x 32	60.3 x 42.4	64	G3402
2" x 1-1/2"	50 x 40	60.3 x 48.3	64	G3403
2-1/2" x 1"	65 x 25	73.0 x 33.7	64	G3404
2-1/2" x 1-1/4"	65 x 32	73.0 x 42.4	64	G3405
2-1/2" x 1-1/2"	65 x 40	73.0 x 48.3	64	G3406
2-1/2" x 2"	65 x 50	73.0 x 60.3	64	G3407
2-1/2" x 2"	65 x 50	76.1 x 60.3	64	G3408
3" x 1"	80 x 25	88.9 x 33.7	64	G3409
3" x 1-1/2"	80 x 40	88.9 x 48.3	64	G3410
3" x 2"	80 x 50	88.9 x 60.3	64	G3411
3" x 2-1/2"	80 x 65	88.9 x 73.0	64	G3412
4" x 1"	100 x 25	114.3 x 33.7	76.1	G3413
4" x 1-1/2"	100 x 40	114.3 x 48.3	76.1	G3414
4" x 2"	100 x 50	114.3 x 60.3	76.1	G3415
4" x 2-1/2"	100 x 65	114.3 x 73.0	76.1	G3416
4" x 3"	100 x 80	114.3 x 88.9	76.1	G3417