

Grooved concentric reducer with female threaded outlet

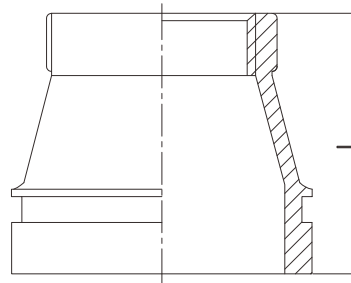

- Certificate: UL Listed / FM Approved
- Standard: ANSI / UL 213C
- Material: Ductile iron ASTM A536, 65-45-12
- Thread run: Female thread, NPT / BSPT
- Rated pressure: 300 ~ 500 psi
- Surface: Red painting / hot dip galvanized



Available size

Inch	Size		End to end L (mm)	Ref. No.
	DN	mm		
1-1/2" x 1"	40 x 25	48.3 x 33.7	64	G3301 (UL)
2" x 1/2"	50 x 15	60.3 x 21.3	64	G3302 (UL/FM)
2" x 3/4"	50 x 20	60.3 x 26.9	64	G3303 (UL/FM)
2" x 1"	50 x 25	60.3 x 33.7	64	G3304 (UL/FM)
2" x 1-1/4"	50 x 32	60.3 x 42.4	64	G3305 (UL/FM)
2" x 1-1/2"	50 x 40	60.3 x 48.3	64	G3306 (UL/FM)
2-1/2" x 1"	65 x 25	73.0 x 33.7	64	G3307 (UL/FM)
2-1/2" x 1-1/4"	65 x 32	73.0 x 42.4	64	G3308 (UL/FM)
2-1/2" x 1-1/2"	65 x 40	73.0 x 48.3	64	G3309 (UL/FM)
2-1/2" x 2"	65 x 50	73.0 x 60.3	64	G3310 (UL/FM)
2-1/2" x 1/2"	65 x 15	76.1 x 21.3	64	G3311 (UL/FM)
2-1/2" x 3/4"	65 x 20	76.1 x 26.9	64	G3312 (UL/FM)
2-1/2" x 1"	65 x 25	76.1 x 33.7	64	G3313 (UL/FM)
2-1/2" x 1-1/4"	65 x 32	76.1 x 42.4	64	G3314 (UL/FM)
2-1/2" x 1-1/2"	65 x 40	76.1 x 48.3	64	G3315 (UL/FM)

Grooved concentric reducer with female threaded outlet

Available size

Size			End to end	Ref. No.
Inch	DN	mm	L (mm)	
2-1/2" x 2"	65 x 50	76.1 x 60.3	64	G3316 (UL/FM)
3" x 1"	80 x 25	88.9 x 33.7	64	G3317 (UL/FM)
3" x 1-1/4"	80 x 32	88.9 x 42.4	64	G3318 (UL/FM)
3" x 1-1/2"	80 x 40	88.9 x 48.3	64	G3319 (UL/FM)
3" x 2"	80 x 50	88.9 x 60.3	64	G3320 (UL/FM)
3" x 2-1/2"	80 x 65	88.9 x 73.0	64	G3321 (UL/FM)
3" x 2-1/2"	80 x 65	88.9 x 76.1	64	G3322 (UL/FM)
4" x 1"	100 x 25	114.3 x 33.7	76	G3323 (UL/FM)
4" x 1-1/4"	100 x 32	114.3 x 42.4	76	G3324 (UL/FM)
4" x 1-1/2"	100 x 40	114.3 x 48.3	76	G3325 (UL/FM)
4" x 2"	100 x 50	114.3 x 60.3	76	G3326 (UL/FM)
4" x 2-1/2"	100 x 65	114.3 x 73.0	76	G3327 (UL/FM)
4" x 2-1/2"	100 x 65	114.3 x 76.1	76	G3328 (UL/FM)
4" x 3"	100 x 80	114.3 x 88.9	76	G3329 (UL/FM)
5" x 1"	125 x 25	139.7 x 33.7	89	G3330 (UL/FM)
5" x 1-1/4"	125 x 32	139.7 x 42.4	89	G3331 (UL/FM)
5" x 1-1/2"	125 x 40	139.7 x 48.3	89	G3332 (UL/FM)
5" x 2"	125 x 50	139.7 x 60.3	89	G3333 (UL/FM)
5" x 2-1/2"	125 x 65	139.7 x 76.1	89	G3334 (UL/FM)
5" x 3"	125 x 80	139.7 x 88.9	89	G3335 (UL/FM)
5" x 4"	125 x 100	139.7 x 114.3	89	G3336 (UL/FM)
6" x 1"	150 x 25	165.1 x 33.7	102	G3337 (UL/FM)
6" x 1-1/4"	150 x 32	165.1 x 42.4	102	G3338 (UL/FM)
6" x 1-1/2"	150 x 40	165.1 x 48.3	102	G3339 (UL/FM)
6" x 2"	150 x 50	165.1 x 60.3	102	G3340 (UL/FM)
6" x 2-1/2"	150 x 65	165.1 x 76.1	102	G3341 (UL/FM)
6" x 3"	150 x 80	165.1 x 88.9	102	G3342 (UL/FM)
6" x 4"	150 x 100	165.1 x 114.3	102	G3343 (UL/FM)
6" x 1"	150 x 25	168.3 x 33.7	102	G3344 (UL/FM)
6" x 2"	150 x 50	168.3 x 60.3	102	G3345 (UL/FM)
6" x 3"	150 x 80	168.3 x 88.9	102	G3346 (UL/FM)
6" x 4"	150 x 100	168.3 x 114.3	102	G3347 (UL/FM)
8" x 1-1/2"	200 x 40	219.1 x 48.3	127	G3348 (UL/FM)

Grooved concentric reducer with female threaded outlet

Available size

Size			End to end	Ref. No.
Inch	DN	mm	L (mm)	
6" x 4"	150 x 100	168.3 x 114.3	102	G3347 (UL/FM)
8" x 1-1/2"	200 x 40	219.1 x 48.3	127	G3348 (UL/FM)
8" x 2"	200 x 50	219.1 x 60.3	127	G3349 (UL/FM)
8" x 2-1/2"	200 x 65	219.1 x 76.1	127	G3350 (UL/FM)
8" x 3"	200 x 80	219.1 x 88.9	127	G3351 (UL/FM)
8" x 4"	200 x 100	219.1 x 114.3	127	G3352 (UL/FM)