

Grooved straight cross (Equal cross)

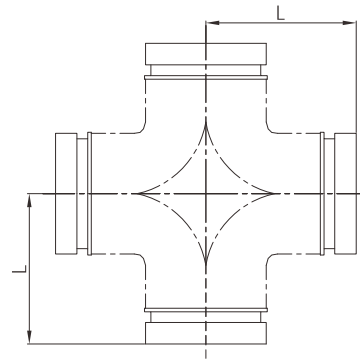

- Certificate: UL Listed / FM Approved
- Standard: ANSI / UL 213C
- Material: Ductile iron ASTM A536, 65-45-12
- Rated pressure: 300 ~ 500 psi
- Surface: Red painting / hot dip galvanized



Available size

Inch	Size		Center to end	Ref. No.
	DN	mm	L (mm)	
1-1/4"	32	42.4	70	G2502
1-1/2"	40	48.3	70	G2503
2"	50	60.3	70	G2504
2-1/2"	65	73.0	76	G2505
2-1/2"	65	76.1	76	G2506
3"	80	88.9	86	G2507
4"	100	114.3	101	G2508
5"	125	139.7	124	G2509
5"	125	141.3	124	G2510
6"	150	165.1	140	G2511
6"	150	168.3	140	G2512
8"	200	219.1	175	G2513
10"	250	273.0	215	G2514
12"	300	323.9	254	G2515