

Grooved 11.25° elbow

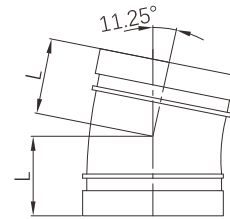

- Certificate: UL Listed / FM Approved
- Standard: ANSI / UL 213C
- Material: Ductile iron ASTM A536, 65-45-12
- Type: Standard radius
- Rated pressure: 300 ~ 500 psi
- Surface: Red painting / hot dip galvanized



Available size

Inch	Size		Center to end	Ref. No.
	DN	mm	L (mm)	
1"	25	33.7	35	G0901
1-1/4"	32	42.4	35	G0902
1-1/2"	40	48.3	35	G0903
2"	50	60.3	35	G0904
2-1/2"	65	73.0	38	G0905
2-1/2"	65	76.1	38	G0906
3"	80	88.9	38	G0907
4"	100	114.3	48	G0908
5"	125	139.7	51	G0909
6"	150	165.1	51	G0911
6"	150	168.3	51	G0912
8"	200	219.1	51	G0913
10"	250	273.0	54	G0914
12"	300	323.9	57	G0915