

Grooved x female threaded adapter elbow

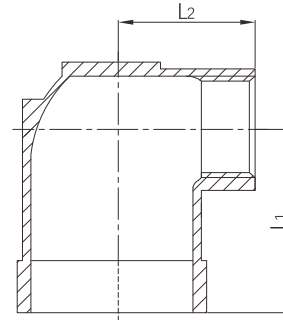

- Certificate: UL Listed / FM Approved
- Standard: ANSI / UL 213C
- Material: Ductile iron ASTM A536, 65-45-12
- Thread run: Female thread, NPT / BSPT
- Rated pressure: 300 ~ 500 psi
- Surface: Red painting / hot dip galvanized



Available size

Inch	Size		Center to end (mm)		Ref. No.
	DN	mm	L1	L2	
1-1/4" x 1/2"	32 x 15	42.4 x 21.3	45	31	G0401
1-1/4" x 3/4"	32 x 20	42.4 x 26.9	45	31	G0402
1-1/4" x 1"	32 x 25	42.4 x 33.7	49	32	G0403
1-1/2" x 1/2"	40 x 15	48.3 x 21.3	45	34	G0404
1-1/2" x 3/4"	40 x 20	48.3 x 26.9	45	34	G0405
1-1/2" x 1"	40 x 25	48.3 x 33.7	49	36	G0406
2" x 1/2"	50 x 15	60.3 x 21.3	45	40	G0407
2" x 3/4"	50 x 20	60.3 x 26.9	45	40	G0408
2" x 1"	50 x 25	60.3 x 33.7	49	42	G0409
2-1/2" x 1/2"	65 x 15	73.0 x 21.3	45	45	G0410
2-1/2" x 3/4"	65 x 20	73.0 x 26.9	45	45	G0411
2-1/2" x 1"	65 x 25	73.0 x 33.7	49	46	G0412