

## Malleable iron straight coupling (Socket)

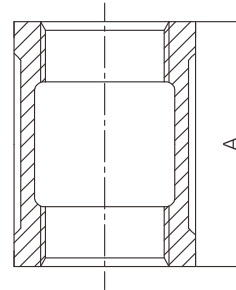

- Certificate: UL Listed / FM Approved
- Standard: ASME B16.3
- Material: Malleable iron ASTM A197
- Thread: NPT
- W. pressure: Class 150, 300 psi (-29°C to 66°C)  
Class 300, 1000 / 1500 / 2000 psi (-29°C to 66°C)
- Surface: Black iron / hot dip galvanized



### Available size (Class 150)

Inch	Size		A	Ref. No.
	DN	mm	mm	
1/2"	15	21.3	34.0	M7303 (UL/FM)
3/4"	20	26.7	38.6	M7304 (UL/FM)
1"	25	33.4	42.4	M7305 (UL/FM)
1-1/4"	32	42.2	49.0	M7306 (UL/FM)
1-1/2"	40	48.3	54.6	M7307 (UL/FM)
2"	50	60.3	64.3	M7308 (UL/FM)
2-1/2"	65	73.0	73.2	M7309 (UL/FM)
3"	80	88.9	80.8	M7310 (UL/FM)
4"	100	114.3	93.7	M7311 (UL/FM)
5"	125	141.3	95.0	M7312 (ISO)
6"	150	168.3	105.0	M7313 (ISO)

## Malleable iron straight coupling (Socket)

### Available size (Class 300)

Inch	Size		A	Ref. No.
	DN	mm	mm	
1/4"	8	13.7	35.1	M7301-300 (ISO)
3/8"	10	17.1	41.4	M7302-300 (ISO)
1/2"	15	21.3	47.8	M7303-300 (ISO)
3/4"	20	26.7	54.1	M7304-300 (ISO)
1"	25	33.4	60.5	M7305-300 (ISO)
1-1/4"	32	42.2	73.2	M7306-300 (ISO)
1-1/2"	40	48.3	73.2	M7307-300 (ISO)
2"	50	60.3	92.2	M7308-300 (ISO)
2-1/2"	65	73.0	104.9	M7309-300 (ISO)
3"	80	88.9	104.9	M7310-300 (ISO)
4"	100	114.3	117.0	M7311-300 (ISO)