

## Malleable iron reducing tee (Equal minor run and branch)

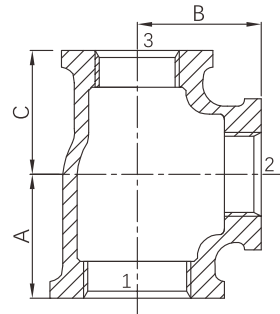

- Certificate: UL Listed / FM Approved
- Standard: ASME B16.3
- Material: Malleable iron ASTM A197
- Thread: NPT
- W. pressure: Class 150, 300 psi (-29°C to 66°C)
- Surface: Black iron / hot dip galvanized



### Available size (Class 150)

Size (1 x 3 x 2)			A	B	C	Ref. No.
Inch	DN	mm	mm	mm	mm	
3/4" x 1/2" x 1/2"	20 x 15 x 15	26.7 x 21.3 x 21.3	30.5	31.0	28.5	M6210 (UL/FM)
1" x 1/2" x 1/2"	25 x 15 x 15	33.4 x 21.3 x 21.3	32.0	35.5	38.5	M6213 (UL/FM)
1" x 3/4" x 3/4"	25 x 20 x 20	33.4 x 26.7 x 26.7	34.8	36.8	33.3	M6214 (UL/FM)
1-1/4" x 1/2" x 1/2"	32 x 15 x 15	42.2 x 21.3 x 21.3	34.0	38.0	27.0	M6216 (FM)
1-1/4" x 3/4" x 3/4"	32 x 20 x 20	42.2 x 26.7 x 26.7	36.8	41.2	33.3	M6217 (UL/FM)
1-1/4" x 1" x 1"	32 x 25 x 25	42.2 x 33.4 x 33.4	40.1	42.4	38.1	M6218 (UL/FM)
1-1/2" x 3/4" x 3/4"	40 x 20 x 20	48.3 x 26.7 x 26.7	38.0	43.0	32.0	M6222 (FM)
1-1/2" x 1" x 1"	40 x 25 x 25	48.3 x 33.4 x 33.4	41.9	45.7	38.1	M6223 (UL/FM)
1-1/2" x 1-1/4" x 1-1/4"	40 x 32 x 32	48.3 x 42.2 x 42.2	46.2	47.8	44.5	M6224 (UL/FM)
2" x 1" x 1"	50 x 25 x 25	60.3 x 33.4 x 33.4	44.0	51.0	38.0	M6229 (FM)
2" x 1-1/4" x 1-1/4"	50 x 32 x 32	60.3 x 42.2 x 42.2	48.3	53.3	44.5	M6230 (UL/FM)
2" x 1-1/2" x 1-1/2"	50 x 40 x 40	60.3 x 48.3 x 48.3	51.3	54.9	49.3	M6231 (UL/FM)
2-1/2" x 2" x 2"	65 x 50 x 50	76.1 x 60.3 x 60.3	60.7	66.0	57.2	M6237 (UL/FM)
3" x 2" x 2"	80 x 50 x 50	88.9 x 60.3 x 60.3	64.0	73.4	57.2	M6244 (UL/FM)