

Malleable cast iron 45° male and female long sweep bend

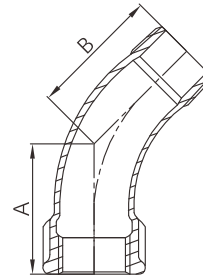

- Certificate: UL Listed / FM Approved
- Standard: ISO 49 / EN 10242, symbol C
- Material: BS EN 1562, EN-GJMB-350-10
- Thread: BSPT
- W. pressure: 20 ~ 25 bar, ≤ PN25
- Surface: Black iron / hot dip galvanized



Available size

Size			A	B	Ref. No.
Inch	DN	mm	mm	mm	
1/4"	8	13.5	26	21	M4701 (UL/FM)
3/8"	10	17.2	30	24	M4702 (UL/FM)
1/2"	15	21.3	36	30	M4703 (UL/FM)
3/4"	20	26.9	43	36	M4704 (UL/FM)
1"	25	33.7	51	42	M4705 (UL/FM)
1-1/4"	32	42.4	64	54	M4706 (UL/FM)
1-1/2"	40	48.3	68	58	M4707 (UL/FM)
2"	50	60.3	81	70	M4708 (UL/FM)
2-1/2"	65	76.1	99	86	M4709 (UL/FM)
3"	80	88.9	113	100	M4710 (UL/FM)
4"	100	114.3	142	126	M4711 (UL/FM)