

Malleable cast iron male and female union elbow (Flat / taper seat)

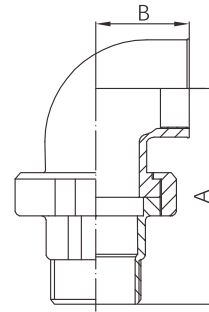

- Certificate: FM Approved / NSF 61
- Standard: ISO 49 / EN 10242, symbol C
- Material: BS EN 1562, EN-GJMB-350-10
- Type: Flat seat / taper seat
- Thread: BSPT
- W. pressure: 20 ~ 25 bar, ≤ PN25
- Surface: Black iron / hot dip galvanized



Available size

Inch	Size		A mm	B mm	Type	Ref. No.
	DN	mm				
1/2"	15	21.3	76	28	Flat seat / taper seat	M4103 (FM)
3/4"	20	26.9	82	33	Flat seat / taper seat	M4104 (FM)
1"	25	33.7	94	38	Flat seat / taper seat	M4105 (FM)
1-1/4"	32	42.4	107	45	Flat seat / taper seat	M4106 (FM)
1-1/2"	40	48.3	115	50	Flat seat / taper seat	M4107 (FM)
2"	50	60.3	128	58	Flat seat / taper seat	M4108 (ISO)

Note:

1. For flat seat, it must be fitted together with gasket for sealing, and TPMC could supply rubber gasket separately.
2. For taper (conical) seat, it is self-sealing without gasket.
3. For taper seat material of head and tail, it is malleable iron, and also available with both brass rings as customized.
4. NSF 61 certificate is available for M4103 ~ M4108.