

Malleable cast iron male and female union (Flat / taper seat)

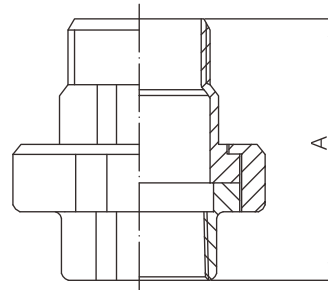

- Certificate: FM Approved / NSF 61
- Standard: ISO 49 / EN 10242, symbol C
- Material: BS EN 1562, EN-GJMB-350-10
- Type: Flat seat / taper seat
- Thread: BSPT
- W. pressure: 20 ~ 25 bar, ≤ PN25
- Surface: Black iron / hot dip galvanized



Available size

Size			A	Type	Ref. No.
Inch	DN	mm	mm		
1/2"	15	21.3	66	Flat seat / taper seat	M3903 (FM)
3/4"	20	26.9	72	Flat seat / taper seat	M3904 (FM)
1"	25	33.7	80	Flat seat / taper seat	M3905 (FM)
1-1/4"	32	42.4	90	Flat seat / taper seat	M3906 (FM)
1-1/2"	40	48.3	95	Flat seat / taper seat	M3907 (FM)
2"	50	60.3	106	Flat seat / taper seat	M3908 (FM)
2-1/2"	65	76.1	118	Flat seat / taper seat	M3909 (FM)
3"	80	88.9	130	Flat seat / taper seat	M3910 (FM)
4"	100	114.3	133	Flat seat / taper seat	M3911 (FM)

Note:

1. For flat seat, it must be fitted together with gasket for sealing, and TPMC could supply rubber gasket separately.
2. For taper (conical) seat, it is self-sealing without gasket.
3. For taper seat material of head and tail, it is malleable iron, and also available with both brass rings as customized.
4. NSF 61 certificate is available for M3903 ~ M3908, except M3909 ~ M3911.