

Malleable cast iron reducing tee (Equal major run and branch)

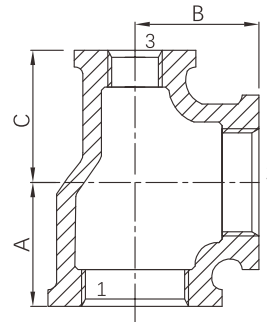

- Certificate: UL Listed / FM Approved / NSF 61
- Standard: ISO 49 / EN 10242, symbol C
- Material: BS EN 1562, EN-GJMB-350-10
- Thread: BSPT
- W. pressure: 20 ~ 25 bar, ≤ PN25
- Surface: Black iron / hot dip galvanized



Available size

Size (1 x 3 x 2)			A	B	C	Ref. No.
Inch	DN	mm	mm	mm	mm	
3/4" x 1/2" x 3/4"	20 x 15 x 20	26.9 x 21.3 x 26.9	33	33	31	M1310 (UL/FM)
1" x 1/4" x 1"	25 x 8 x 25	33.7 x 13.7 x 33.7	38	38	30	M1311 (UL/FM)
1" x 1/2" x 1"	25 x 15 x 25	33.7 x 21.3 x 33.7	38	38	34	M1312 (UL/FM)
1" x 3/4" x 1"	25 x 20 x 25	33.7 x 26.9 x 33.7	38	38	36	M1313 (UL/FM)
1-1/4" x 1/2" x 1-1/4"	32 x 15 x 32	42.4 x 21.3 x 42.4	45	45	38	M1316 (UL/FM)
1-1/4" x 3/4" x 1-1/4"	32 x 20 x 32	42.4 x 26.9 x 42.4	45	45	41	M1317 (UL/FM)
1-1/4" x 1" x 1-1/4"	32 x 25 x 32	42.4 x 33.7 x 42.4	45	45	42	M1318 (UL/FM)
1-1/2" x 1/2" x 1-1/2"	40 x 15 x 40	48.3 x 21.3 x 48.3	50	50	42	M1321 (UL/FM)
1-1/2" x 3/4" x 1-1/2"	40 x 20 x 40	48.3 x 26.9 x 48.3	50	50	44	M1322 (UL/FM)
1-1/2" x 1" x 1-1/2"	40 x 25 x 40	48.3 x 33.7 x 48.3	50	50	46	M1323 (UL/FM)
1-1/2" x 1-1/4" x 1-1/2"	40 x 32 x 40	48.3 x 42.4 x 48.3	50	50	48	M1324 (UL/FM)
2" x 1/2" x 2"	50 x 15 x 50	60.3 x 21.3 x 60.3	58	58	48	M1325 (UL/FM)
2" x 3/4" x 2"	50 x 20 x 50	60.3 x 26.9 x 60.3	58	58	50	M1327 (UL/FM)
2" x 1" x 2"	50 x 25 x 50	60.3 x 33.7 x 60.3	58	58	52	M1329 (UL/FM)
2" x 1-1/4" x 2"	50 x 32 x 50	60.3 x 42.4 x 60.3	58	58	54	M1330 (UL/FM)
2" x 1-1/2" x 2"	50 x 40 x 50	60.3 x 48.3 x 60.3	58	58	55	M1331 (UL/FM)
2-1/2" x 1-1/2" x 2-1/2"	65 x 40 x 65	76.1 x 48.3 x 76.1	68	68	64	M1332 (UL/FM)
2-1/2" x 2" x 2-1/2"	65 x 50 x 65	76.1 x 60.3 x 76.1	68	68	65	M1337 (UL/FM)

Note: NSF 61 certificate is available for M1310 ~ M1337, except M1311.