

Malleable cast iron male and female 45° elbow

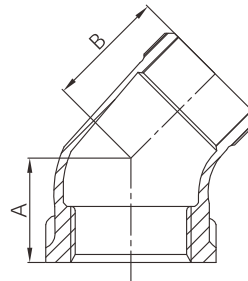

- Certificate: UL Listed / FM Approved / NSF 61
- Standard: ISO 49 / EN 10242, symbol C
- Material: BS EN 1562, EN-GJMB-350-10
- Thread: BSPT
- W. pressure: 20 ~ 25 bar, ≤ PN25
- Surface: Black iron / hot dip galvanized



Available size

Inch	Size		A mm	B mm	Ref. No.
	DN	mm			
1/4"	8	13.5	19	24	M0601 (UL)
3/8"	10	17.2	20	25	M0602 (UL/FM)
1/2"	15	21.3	22	28	M0603 (UL/FM)
3/4"	20	26.9	25	32	M0604 (UL/FM)
1"	25	33.7	28	37	M0605 (UL/FM)
1-1/4"	32	42.4	33	43	M0606 (UL/FM)
1-1/2"	40	48.3	36	46	M0607 (UL/FM)
2"	50	60.3	43	55	M0608 (UL/FM)
2-1/2"	65	76.1	50	65	M0609 (UL/FM)
3"	80	88.9	55	76	M0610 (UL/FM)
4"	100	114.3	66	94	M0611 (UL/FM)

Note: NSF 61 certificate is available for M0601, M0602.