

## Flush fire department inlet connection (Clapper body)

Fire department inlet connection (Siamese connection) is used as an auxiliary connection to supplement water from its inlet. For flush FDC, the body is concealed behind the wall for aesthetic appearance and unobstructed passage.

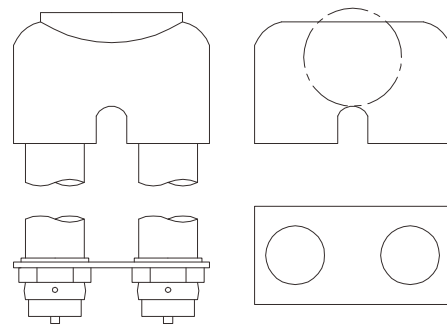

- Certificate: UL listed / FM Approved
- Standard: ANSI / UL 405
- Feature: Flush clapper body inlet
- W. pressure: 175 psi
- Surface: Polished / chrome plated



### Main parts and material

<b>Body</b>	Cast brass, equipped with clappers	<b>Clapper</b>	Brass, individual body drop clapper
<b>Plug</b>	Brass, pin lug, with chain	<b>Wall plate</b>	Brass, special lettering for identification

### Available size

Size	Way of inlet	Clapper	Body pattern	Inlet	Outlet	Working pressure (psi)	Ref. No.
2-1/2" x 4"	2-way	Double	Straight	(2) 2-1/2" NH, F	4" FNPT / GRV	175	F0401 (UL/FM)
2-1/2" x 4"	2-way	Double	Angle	(2) 2-1/2" NH, F	4" FNPT / GRV	175	F0402 (UL/FM)
2-1/2" x 6"	2-way	Double	Straight	(2) 2-1/2" NH, F	6" FNPT / GRV	175	F0403 (UL/FM)
2-1/2" x 6"	2-way	Double	Angle	(2) 2-1/2" NH, F	6" FNPT / GRV	175	F0404 (UL/FM)
3" x 4"	2-way	Double	Straight	(2) 3" NH, F	4" FNPT / GRV	175	F0405 (UL/FM)
3" x 4"	2-way	Double	Angle	(2) 3" NH, F	4" FNPT / GRV	175	F0406 (UL/FM)
3" x 6"	2-way	Double	Straight	(2) 3" NH, F	6" FNPT / GRV	250	F0407 (UL/FM)
3" x 6"	2-way	Double	Angle	(2) 3" NH, F	6" FNPT / GRV	250	F0408 (UL/FM)

## Flush fire department inlet connection (Clapper body)

### Available size

Size	Way of inlet	Clapper	Body pattern	Inlet	Outlet	Working pressure (psi)	Ref. No.
2-1/2" x 6"	3-way	Three	Straight	(3) 2-1/2" NH, F	6" NPT, F	175	F0409 (ISO)
2-1/2" x 6"	3-way	Three	Angle	(3) 2-1/2" NH, F	6" NPT, F	175	F0410 (ISO)
2-1/2" x 6"	4-way	Four	Straight	(4) 2-1/2" NH, F	6" NPT, F	175	F0411 (ISO)
2-1/2" x 6"	4-way	Four	Angle	(4) 2-1/2" NH, F	6" NPT, F	175	F0412 (ISO)
2-1/2" x 6"	4-way	Four	End	(4) 2-1/2" NH, F	6" NPT, F	175	F0413 (ISO)
2-1/2" x 6"	6-way	Six	Straight	(6) 2-1/2" NH, F	6" NPT, F	175	F0414 (ISO)
2-1/2" x 6"	6-way	Six	Angle	(6) 2-1/2" NH, F	6" NPT, F	175	F0415 (ISO)
2-1/2" x 6"	6-way	Six	End	(6) 2-1/2" NH, F	6" NPT, F	175	F0416 (ISO)
2-1/2" x 8"	6-way	Six	Straight	(6) 2-1/2" NH, F	8" NPT, F	175	F0417 (ISO)
2-1/2" x 8"	6-way	Six	Angle	(6) 2-1/2" NH, F	8" NPT, F	175	F0418 (ISO)
2-1/2" x 8"	6-way	Six	End	(6) 2-1/2" NH, F	8" NPT, F	175	F0419 (ISO)

**Note:** The FDC assembly includes 3 parts: FDC body, plug with chain, and wall plate.