

Air/vacuum valve (Well service air valve)

Air/vacuum valve is used to exhaust large quantity of air automatically at system start-up, and to admit large quantity of air automatically when the internal pressure in the pipeline drops below atmospheric pressure.

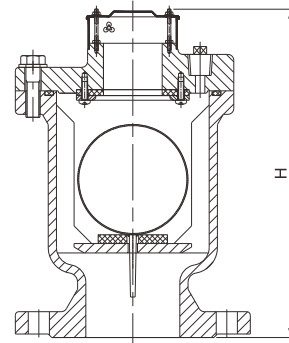

- Certificate: UL Listed
- Standard: UL 2573, NFPA 20, AWWA C512
- Connection: Flanged as B16.1 Class 125, B16.5 Class 150, etc.
- Feature: Large orifice, vent and admit air
- Temperature: 0 ~ 80°C
- W. pressure: 300 psi
- Surface: FBE coating as AWWA C550



Main parts and material

Body / bonnet	Ductile iron as ASTM A536, 65-45-12	Float ball assembly	SS 304
Internal trim parts	SS 304	Seal	EPDM

Available size

Inlet	Outlet	Orifice	Dimension (mm)	Working pressure (psi)	Ref. No.
			H		
2" FLG	1-1/4" NPT	1-1/4"	231	300	U1801
2-1/2" FLG	2" NPT	2"	275	300	U1802
3" FLG	2" NPT	2"	275	300	U1803
4" FLG	2-1/2" NPT	2-1/2"	331	300	U1804