

Flushing flanged basket strainer

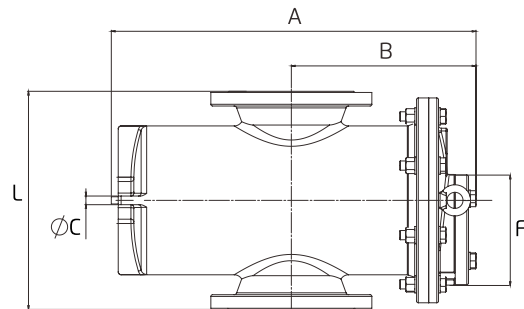

- Certificate: UL Listed
- Standard: UL Subject 321
- Connection: Flanged as B16.42 Class 150 or EN1092-2 PN 16
- Temperature: 90°C
- W. pressure: 200 / 250 psi
- Surface: FBE coating as AWWA C550



Main parts and material

Body / cover	Ductile iron as ASTM A536, 65-45-12	Screen	SS316L, 1/8" (3.2mm) hole diameter, min 40% free flow area
Flushing port	Plug as SS316L, or flange as ductile iron as ASTM A536, 65-45-12	Drain plug	SS316

Available size

Size			Dimension (mm)			Flushing port	Drain plug (NPT /BSPT)	Working pressure (psi)	Ref. No.
Inch	DN	mm	L	A	B				
3"	80	88.9	250	346	184	2" threaded	3/4"	200	V5901
4"	100	114.3	292	440	228	2" threaded	1"	200	V5902
6"	150	168.3	378	623	334	3" #150 FLG	1"	200	V5903
8"	200	219.1	476	718	388	3" #150 FLG	1-1/2"	200	V5904
10"	250	273.0	560	774	416	3" #150 FLG	1-1/2"	200	V5905
12"	300	323.8	680	989	502	3" #150 FLG	2"	200	V5906
14"	350	355.6	768	1125	515	4" #150 FLG	2"	250	V5907
16"	400	406.4	845	1215	554	6" #150 FLG	2"	250	V5908

Note:

1. The max allowable pressure drop is 7 psi across the strainer.
2. It can be supplied with flush valve together, ball valve or gate valve.