

Cup nut loop hanger

Pipe hanger is a device or assembly used to support the gravity load of the system piping. Cup nut loop hanger provides vertical adjustment that utilizes nuts and formed steel strap looped around the pipe.

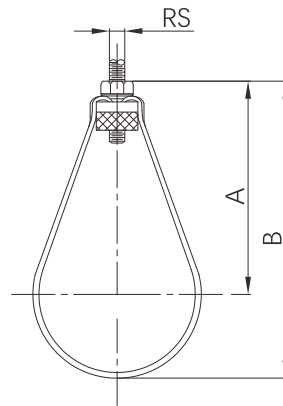

- Certificate: FM Approved
- Standard: Refer to MSS SP-58/69 (Type-7)
- Material: Carbon steel
- Configuration: Complete set, with flange nut and cup nut
- Surface: Pre-galvanized / electro-galvanized
- Application: Non-insulated stationary pipeline



Available size

Pipe size		Hanger Rod Size (RS)		Dimension (mm)		Max recommend load (N)	Ref. No.
NPS	DN	UNC	Metric	A	B		
1"	25	3/8"	M10	55	74	2220	P4303
1-1/4"	32	3/8"	M10	55	79	2220	P4304
1-1/2"	40	3/8"	M10	60	87	2220	P4305
2"	50	3/8"	M10	70	103	2220	P4306
2-1/2"	65	3/8"	M10	93	132	4440	P4307
3"	80	3/8"	M10	105	153	4440	P4308
4"	100	3/8"	M10	130	190	4440	P4309
5"	125	1/2"	M12	145	220	8450	P4310
6"	150	1/2"	M12	175	263	8450	P4311
8"	200	1/2"	M12	225	338	8450	P4312