

Bib-nosed high pressure wet landing valve (PRV)

High pressure wet landing valve, also known as pressure regulating valve (PRV), is designed to reduce inlet pressure, so to maintain a constant reduced outlet pressure. It is field adjustable and used in wet riser.

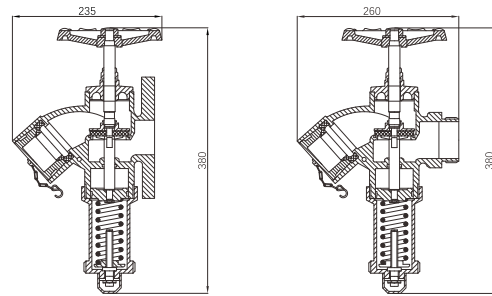

- Certificate: BSI / LPCB Approved
- Standard: BS 5041-1, BS 5154 globe type
- Connection: Flanged to EN 1092-3, or screwed to ISO 7-1
- Temperature: 0°C to 38°C
- Test: Body 30 bar / seat 22 bar
- Surface: Red powder coating (RAL 3000)



Main parts and material

DN 65 size

Body / bonnet / disk	Copper alloy, LG2 or CZ122	Pressure regulating spring	Chrome vanadium spring steel to BS970, 735A50
Blank cap	Copper alloy to EN 1982, with chain	Handwheel	Grey cast iron to BS 1452

Available size

Size	Type	Inlet	Outlet	Working pressure (bar)	Ref. No.
DN 50	Bib-nosed	Flanged DN 50, PN 25	2.5" BS336	20	FE1401
DN 65	Bib-nosed	Flanged DN 65, PN 25	2.5" BS336	20	FE1402
DN 65	Bib-nosed	2.5" BSPT, M	2.5" BS336	20	FE1403

Note:

1. The inlet pressure ranges from 5.7 to 20 bar.
2. The outlet pressure regulation ranges from 0 to 12 bar.
3. As factory preset, the outlet static pressure is set at 7.0 bar (100 psi).
4. Please refer to LPCB certificate (Cert No 1153Le) as our TPMC brand, with model F29-50, F29-65, F30-65T.